



TANDREMSKIVER - FORBORET

TIMING BELT PULLEYS - PILOT BORE

ZAHNRIEMENSCHHEIBEN - VORGEBOHRT

Leveringsprogram Product Range Lieferprogramm	Side Page Seite
3M HTD®	62
3MR® GT®	63
5M HTD®	64
5MR® GT®	66
8M HTD®-GT®	68
14M HTD®-GT®	70
XL 1/5" (5,08 mm)	72
L 3/8" (9,525 mm)	73
H 1/2" (12,7 mm)	75
T 2,5 (2,5 mm)	78
T 5 (5 mm)	79
AT 5 (5 mm)	81
T 10 (10 mm)	83
AT 10 (10 mm)	85

Mål og materialegengivelser er med forbehold.
All dimensions and materials may be subject to change.
Mass- und Materialabweichungen vorbehalten.

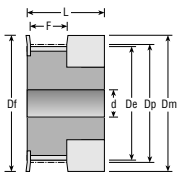

Figur 1F

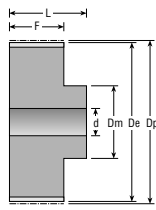

Figur 6

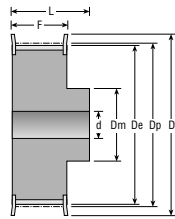

Figur 6F

Z	Rembr. Belt w. Riemenbr.	Mat.	Fig.	Best. nr. Part No. Best. Nr.	Dp	De	Df	Dm	Di	F	L	d	Vægt Weight Gewicht
10	9	AL	1F	0103M009N	9,55	8,79	13,0	13,0	-	10,2	17,5	-	0,004
	15	AL	1F	0103M015N	9,55	8,79	13,0	13,0	-	17,0	26,0	-	0,006
12	9	AL	1F	0123M009N	11,46	10,70	15,0	15,0	-	10,2	17,5	-	0,006
	15	AL	1F	0123M015N	11,46	10,70	15,0	15,0	-	17,0	26,0	-	0,008
14	9	AL	1F	0143M009N	13,37	12,61	16,0	16,0	-	10,2	17,5	-	0,007
	15	AL	1F	0143M015N	13,37	12,61	16,0	16,0	-	17,0	26,0	-	0,010
15	9	AL	1F	0153M009N	14,32	13,56	17,5	17,5	-	10,2	17,5	-	0,008
	15	AL	1F	0153M015N	14,32	13,56	17,5	17,5	-	17,0	26,0	-	0,012
16	9	AL	6F	0163M009N	15,28	14,52	18,0	9,5	-	12,8	20,6	4,0	0,007
	15	AL	6F	0163M015N	15,28	14,52	18,0	9,5	-	19,5	26,0	4,0	0,010
18	9	AL	6F	0183M009N	17,19	16,43	19,5	10,0	-	12,8	20,6	6,0	0,008
	15	AL	6F	0183M015N	17,19	16,43	19,5	10,0	-	19,5	26,0	6,0	0,012
20	9	AL	6F	0203M009N	19,10	18,34	23,0	12,0	-	12,8	20,6	6,0	0,010
	15	AL	6F	0203M015N	19,10	18,34	23,0	12,0	-	19,5	26,0	6,0	0,014
21	9	AL	6F	0213M009N	20,05	19,29	25,0	13,0	-	12,8	20,6	6,0	0,013
	15	AL	6F	0213M015N	20,05	19,29	25,0	13,0	-	19,5	26,0	6,0	0,016
22	9	AL	6F	0223M009N	21,01	20,25	25,0	13,0	-	12,8	20,6	6,0	0,014
	15	AL	6F	0223M015N	21,01	20,25	25,0	13,0	-	19,5	26,0	6,0	0,018
24	9	AL	6F	0243M009N	22,92	22,16	25,0	13,0	-	12,8	20,6	6,0	0,016
	15	AL	6F	0243M015N	22,92	22,16	25,0	13,0	-	19,5	26,0	6,0	0,020
26	9	AL	6F	0263M009N	24,83	24,07	28,0	16,0	-	12,8	20,6	6,0	0,018
	15	AL	6F	0263M015N	24,83	24,07	28,0	16,0	-	19,5	26,0	6,0	0,027
28	9	AL	6F	0283M009N	26,74	25,98	32,0	18,0	-	12,8	20,6	6,0	0,024
	15	AL	6F	0283M015N	26,74	25,98	32,0	18,0	-	19,5	26,0	6,0	0,030
30	9	AL	6F	0303M009N	28,65	27,89	32,0	19,0	-	12,8	20,6	6,0	0,028
	15	AL	6F	0303M015N	28,65	27,89	32,0	19,0	-	19,5	26,0	6,0	0,035
32	9	AL	6F	0323M009N	30,56	29,80	36,0	22,0	-	12,8	20,6	6,0	0,032
	15	AL	6F	0323M015N	30,56	29,80	36,0	22,0	-	19,5	26,0	6,0	0,042
36	9	AL	6F	0363M009N	34,38	33,62	38,0	26,0	-	13,4	22,2	6,0	0,045
	15	AL	6F	0363M015N	34,38	33,62	38,0	26,0	-	20,0	30,0	6,0	0,060
40	9	AL	6F	0403M009N	38,20	37,44	42,0	28,0	-	13,4	22,2	6,0	0,055
	15	AL	6F	0403M015N	38,20	37,44	42,0	28,0	-	20,0	30,0	6,0	0,075
44	9	AL	6F	0443M009N	42,02	41,26	48,0	33,0	-	13,4	22,2	6,0	0,074
	15	AL	6F	0443M015N	42,02	41,26	48,0	33,0	-	20,0	30,0	6,0	0,100
48	9	AL	6	0483M009N	45,84	45,08	-	33,0	-	13,4	22,2	8,0	0,074
	15	AL	6	0483M015N	45,84	45,08	-	33,0	-	20,0	30,0	8,0	0,103
60	9	AL	6	0603M009N	57,30	56,54	-	33,0	-	13,4	22,2	8,0	0,106
	15	AL	6	0603M015N	57,30	56,54	-	33,0	-	20,0	30,0	8,0	0,150
72	9	AL	6	0723M009N	68,75	67,99	-	33,0	-	13,4	22,2	8,0	0,145
	15	AL	6	0723M015N	68,75	67,99	-	33,0	-	20,0	30,0	8,0	0,212

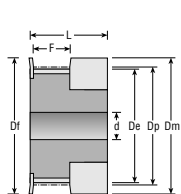

Figur 1F

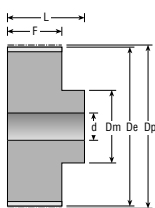

Figur 6

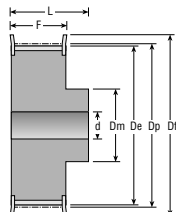

Figur 6F

Z	Rembr. Belt w. Riemenbr.	Mat.	Fig.	Best. nr. Part No. Best. Nr.	Dp	De	Df	Dm	Di	F	L	d	Vægt Weight Gewicht
10	9	AL	1F	0103MR009N	9,55	8,79	13,0	13,0	-	10,2	17,5	-	0,004
	15	AL	1F	0103MR015N	9,55	8,79	13,0	13,0	-	17,0	26,0	-	0,006
12	9	AL	1F	0123MR009N	11,46	10,70	15,0	15,0	-	10,2	17,5	-	0,006
	15	AL	1F	0123MR015N	11,46	10,70	15,0	15,0	-	17,0	26,0	-	0,008
14	9	AL	1F	0143MR009N	13,37	12,61	16,0	16,0	-	10,2	17,5	-	0,007
	15	AL	1F	0143MR015N	13,37	12,61	16,0	16,0	-	17,0	26,0	-	0,010
15	9	AL	1F	0153MR009N	14,32	13,56	17,5	17,5	-	10,2	17,5	-	0,008
	15	AL	1F	0153MR015N	14,32	13,56	17,5	17,5	-	17,0	26,0	-	0,012
16	9	AL	6F	0163MR009N	15,28	14,52	18,0	9,5	-	12,8	20,6	4,0	0,007
	15	AL	6F	0163MR015N	15,28	14,52	18,0	9,5	-	19,5	26,0	4,0	0,010
18	9	AL	6F	0183MR009N	17,19	16,43	19,5	10,0	-	12,8	20,6	6,0	0,008
	15	AL	6F	0183MR015N	17,19	16,43	19,5	10,0	-	19,5	26,0	6,0	0,012
20	9	AL	6F	0203MR009N	19,10	18,34	23,0	12,0	-	12,8	20,6	6,0	0,010
	15	AL	6F	0203MR015N	19,10	18,34	23,0	12,0	-	19,5	26,0	6,0	0,014
21	9	AL	6F	0213MR009N	20,05	19,29	25,0	13,0	-	12,8	20,6	6,0	0,013
	15	AL	6F	0213MR015N	20,05	19,29	25,0	13,0	-	19,5	26,0	6,0	0,016
22	9	AL	6F	0223MR009N	21,01	20,25	25,0	13,0	-	12,8	20,6	6,0	0,014
	15	AL	6F	0223MR015N	21,01	20,25	25,0	13,0	-	19,5	26,0	6,0	0,018
24	9	AL	6F	0243MR009N	22,92	22,16	25,0	13,0	-	12,8	20,6	6,0	0,016
	15	AL	6F	0243MR015N	22,92	22,16	25,0	13,0	-	19,5	26,0	6,0	0,020
26	9	AL	6F	0263MR009N	24,83	24,07	28,0	16,0	-	12,8	20,6	6,0	0,018
	15	AL	6F	0263MR015N	24,83	24,07	28,0	16,0	-	19,5	26,0	6,0	0,027
28	9	AL	6F	0283MR009N	26,74	25,98	32,0	18,0	-	12,8	20,6	6,0	0,024
	15	AL	6F	0283MR015N	26,74	25,98	32,0	18,0	-	19,5	26,0	6,0	0,030
30	9	AL	6F	0303MR009N	28,65	27,89	32,0	19,0	-	12,8	20,6	6,0	0,028
	15	AL	6F	0303MR015N	28,65	27,89	32,0	19,0	-	19,5	26,0	6,0	0,035
32	9	AL	6F	0323MR009N	30,56	29,80	36,0	22,0	-	12,8	20,6	6,0	0,032
	15	AL	6F	0323MR015N	30,56	29,80	36,0	22,0	-	19,5	26,0	6,0	0,042
36	9	AL	6F	0363MR009N	34,38	33,62	38,0	26,0	-	13,4	22,2	6,0	0,045
	15	AL	6F	0363MR015N	34,38	33,62	38,0	26,0	-	20,0	30,0	6,0	0,060
40	9	AL	6F	0403MR009N	38,20	37,44	42,0	28,0	-	13,4	22,2	6,0	0,055
	15	AL	6F	0403MR015N	38,20	37,44	42,0	28,0	-	20,0	30,0	6,0	0,075
44	9	AL	6F	0443MR009N	42,02	41,26	48,0	33,0	-	13,4	22,2	6,0	0,074
	15	AL	6F	0443MR015N	42,02	41,26	48,0	33,0	-	20,0	30,0	6,0	0,100
48	9	AL	6	0483MR009N	45,84	45,08	-	33,0	-	13,4	22,2	8,0	0,074
	15	AL	6	0483MR015N	45,84	45,08	-	33,0	-	20,0	30,0	8,0	0,103
60	9	AL	6	0603MR009N	57,30	56,54	-	33,0	-	13,4	22,2	8,0	0,106
	15	AL	6	0603MR015N	57,30	56,54	-	33,0	-	20,0	30,0	8,0	0,150
72	9	AL	6	0723MR009N	68,75	67,99	-	33,0	-	13,4	22,2	8,0	0,145
	15	AL	6	0723MR015N	68,75	67,99	-	33,0	-	20,0	30,0	8,0	0,212

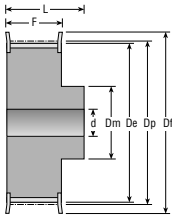

Figur 6F

Z	Rembr. Belt w. Riemenbr.	Mat.	Fig.	Best. nr. Part No. Best. Nr.	Dp	De	Df	Dm	Di	F	L	d	Vægt Weight Gewicht
12	9	ST	6F	0125M009N	19,10	17,96	25,0	13,0	-	14,5	20,0	4,0	0,028
	15	ST	6F	0125M015N	19,10	17,96	25,0	13,0	-	20,5	26,0	4,0	0,034
	25	ST	6F	0125M025N	19,10	17,96	25,0	13,0	-	30,5	36,0	4,0	0,050
14	9	ST	6F	0145M009N	22,28	21,14	25,0	13,0	-	14,5	20,0	6,0	0,034
	15	ST	6F	0145M015N	22,28	21,14	25,0	13,0	-	20,5	26,0	6,0	0,046
	25	ST	6F	0145M025N	22,28	21,14	25,0	13,0	-	30,5	36,0	6,0	0,070
15	9	ST	6F	0155M009N	23,87	22,73	28,0	16,0	-	14,5	20,0	6,0	0,042
	15	ST	6F	0155M015N	23,87	22,73	28,0	16,0	-	20,5	26,0	6,0	0,056
	25	ST	6F	0155M025N	23,87	22,73	28,0	16,0	-	30,5	36,0	6,0	0,080
16	9	ST	6F	0165M009N	25,46	24,32	28,0	16,0	-	14,5	20,0	6,0	0,050
	15	ST	6F	0165M015N	25,46	24,32	28,0	16,0	-	20,5	26,0	6,0	0,064
	25	ST	6F	0165M025N	25,46	24,32	28,0	16,0	-	30,5	36,0	6,0	0,100
18	9	ST	6F	0185M009N	28,65	27,51	32,0	19,0	-	14,5	20,0	6,0	0,070
	15	ST	6F	0185M015N	28,65	27,51	32,0	19,0	-	20,5	26,0	6,0	0,086
	25	ST	6F	0185M025N	28,65	27,51	32,0	19,0	-	30,5	36,0	6,0	0,120
20	9	ST	6F	0205M009N	31,83	30,69	36,0	23,0	-	14,5	22,5	6,0	0,094
	15	ST	6F	0205M015N	31,83	30,69	36,0	23,0	-	20,5	26,0	6,0	0,112
	25	ST	6F	0205M025N	31,83	30,69	36,0	23,0	-	30,5	36,0	6,0	0,160
21	9	ST	6F	0215M009N	33,42	32,28	38,0	24,0	-	14,5	22,5	6,0	0,110
	15	ST	6F	0215M015N	33,42	32,28	38,0	24,0	-	20,5	26,0	6,0	0,130
	25	ST	6F	0215M025N	33,42	32,28	38,0	24,0	-	30,5	38,0	6,0	0,190
22	9	ST	6F	0225M009N	35,01	33,87	38,0	25,5	-	14,5	22,5	6,0	0,118
	15	ST	6F	0225M015N	35,01	33,87	38,0	25,5	-	20,5	26,0	6,0	0,140
	25	ST	6F	0225M025N	35,01	33,87	38,0	25,5	-	30,5	38,0	6,0	0,210
24	9	ST	6F	0245M009N	38,20	37,06	42,0	27,0	-	14,5	22,5	6,0	0,145
	15	ST	6F	0245M015N	38,20	37,06	42,0	27,0	-	20,5	28,0	6,0	0,180
	25	ST	6F	0245M025N	38,20	37,06	42,0	27,0	-	30,5	38,0	6,0	0,250
26	9	ST	6F	0265M009N	41,38	40,24	44,0	30,0	-	14,5	22,5	6,0	0,170
	15	ST	6F	0265M015N	41,38	40,24	44,0	30,0	-	20,5	28,0	6,0	0,220
	25	ST	6F	0265M025N	41,38	40,24	44,0	30,0	-	30,5	38,0	6,0	0,300
28	9	ST	6F	0285M009N	44,56	43,42	48,0	30,5	-	14,5	22,5	6,0	0,200
	15	ST	6F	0285M015N	44,56	43,42	48,0	30,5	-	20,5	28,0	6,0	0,250
	25	ST	6F	0285M025N	44,56	43,42	48,0	30,5	-	30,5	38,0	6,0	0,350
30	9	ST	6F	0305M009N	47,75	46,60	51,0	35,0	-	14,5	22,5	6,0	0,236
	15	ST	6F	0305M015N	47,75	46,60	51,0	35,0	-	20,5	28,0	6,0	0,300
	25	ST	6F	0305M025N	47,75	46,60	51,0	35,0	-	30,5	38,0	6,0	0,420
32	9	ST	6F	0325M009N	50,93	49,79	54,0	38,0	-	14,5	22,5	8,0	0,270
	15	ST	6F	0325M015N	50,93	49,79	54,0	38,0	-	20,5	28,0	8,0	0,350
	25	ST	6F	0325M025N	50,93	49,79	54,0	38,0	-	30,5	38,0	8,0	0,480
36	9	ST	6F	0365M009N	57,30	56,16	60,0	38,0	-	14,5	22,5	8,0	0,324
	15	ST	6F	0365M015N	57,30	56,16	60,0	38,0	-	20,5	28,0	8,0	0,520
	25	ST	6F	0365M025N	57,30	56,16	60,0	38,0	-	30,5	38,0	8,0	0,590
40	9	ST	6F	0405M009N	63,66	62,52	71,00	38,0	-	14,5	22,5	8,0	0,400
	15	ST	6F	0405M015N	63,66	62,52	71,00	38,0	-	20,5	28,0	8,0	0,426
	25	ST	6F	0405M025N	63,66	62,52	71,00	38,0	-	30,5	38,0	8,0	0,740

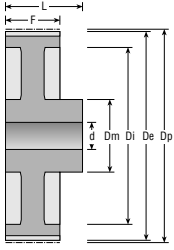

Figur 6W

Z	Rembr. Belt w. Riemenbr.	Mat.	Fig.	Best. nr. Part No. Best. Nr.	Dp	De	Df	Dm	Di	F	L	d	Vægt Weight Gewicht
44	9	AL	6W	0445M009N	70,03	68,89	-	38,0	-	14,5	25,5	8,0	0,170
	15	AL	6W	0445M015N	70,03	68,89	-	38,0	-	20,5	30,0	8,0	0,225
	25	AL	6W	0445M025N	70,03	68,89	-	38,0	-	30,5	40,0	8,0	0,320
48	9	AL	6W	0485M009N	76,39	75,25	-	45,0	-	14,5	25,5	8,0	0,182
	15	AL	6W	0485M015N	76,39	75,25	-	38,0	-	20,5	30,0	8,0	0,187
	25	AL	6W	0485M025N	76,39	75,25	-	38,0	-	30,5	40,0	8,0	0,275
60	9	AL	6W	0605M009N	95,49	94,35	-	45,0	-	14,5	25,5	8,0	0,230
	15	AL	6W	0605M015N	95,49	94,35	-	50,0	-	20,5	30,0	8,0	0,305
	25	AL	6W	0605M025N	95,49	94,35	-	50,0	-	30,5	40,0	8,0	0,435
72	9	AL	6W	0725M009N	114,59	113,45	-	45,0	-	14,5	25,5	8,0	0,270
	15	AL	6W	0725M015N	114,59	113,45	-	50,0	-	20,5	30,0	8,0	0,375
	25	AL	6W	0725M025N	114,59	113,45	-	50,0	-	30,5	40,0	8,0	0,525

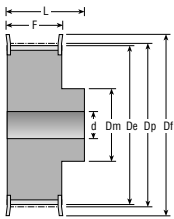

Figur 6F

Z	Rembr. Belt w. Riemenbr.	Mat.	Fig.	Best. nr. Part No. Best. Nr.	Dp	De	Df	Dm	Di	F	L	d	Vægt Weight Gewicht
12	9	ST	6F	0125MR009N	19,10	17,96	25,0	13,0	-	14,5	20,0	4,0	0,028
	15	ST	6F	0125MR015N	19,10	17,96	25,0	13,0	-	20,5	26,0	4,0	0,034
	25	ST	6F	0125MR025N	19,10	17,96	25,0	13,0	-	30,5	36,0	4,0	0,050
14	9	ST	6F	0145MR009N	22,28	21,14	25,0	13,0	-	14,5	20,0	6,0	0,034
	15	ST	6F	0145MR015N	22,28	21,14	25,0	13,0	-	20,5	26,0	6,0	0,046
	25	ST	6F	0145MR025N	22,28	21,14	25,0	13,0	-	30,5	36,0	6,0	0,070
15	9	ST	6F	0155MR009N	23,87	22,73	28,0	16,0	-	14,5	20,0	6,0	0,042
	15	ST	6F	0155MR015N	23,87	22,73	28,0	16,0	-	20,5	26,0	6,0	0,056
	25	ST	6F	0155MR025N	23,87	22,73	28,0	16,0	-	30,5	36,0	6,0	0,080
16	9	ST	6F	0165MR009N	25,46	24,32	28,0	16,0	-	14,5	20,0	6,0	0,050
	15	ST	6F	0165MR015N	25,46	24,32	28,0	16,0	-	20,5	26,0	6,0	0,064
	25	ST	6F	0165MR025N	25,46	24,32	28,0	16,0	-	30,5	36,0	6,0	0,100
18	9	ST	6F	0185MR009N	28,65	27,51	32,0	19,0	-	14,5	20,0	6,0	0,070
	15	ST	6F	0185MR015N	28,65	27,51	32,0	19,0	-	20,5	26,0	6,0	0,086
	25	ST	6F	0185MR025N	28,65	27,51	32,0	19,0	-	30,5	36,0	6,0	0,120
20	9	ST	6F	0205MR009N	31,83	30,69	36,0	23,0	-	14,5	22,5	6,0	0,094
	15	ST	6F	0205MR015N	31,83	30,69	36,0	23,0	-	20,5	26,0	6,0	0,112
	25	ST	6F	0205MR025N	31,83	30,69	36,0	23,0	-	30,5	36,0	6,0	0,160
21	9	ST	6F	0215MR009N	33,42	32,28	38,0	24,0	-	14,5	22,5	6,0	0,110
	15	ST	6F	0215MR015N	33,42	32,28	38,0	24,0	-	20,5	26,0	6,0	0,130
	25	ST	6F	0215MR025N	33,42	32,28	38,0	24,0	-	30,5	38,0	6,0	0,190
22	9	ST	6F	0225MR009N	35,01	33,87	38,0	25,5	-	14,5	22,5	6,0	0,118
	15	ST	6F	0225MR015N	35,01	33,87	38,0	25,5	-	20,5	26,0	6,0	0,140
	25	ST	6F	0225MR025N	35,01	33,87	38,0	25,5	-	30,5	38,0	6,0	0,210
24	9	ST	6F	0245MR009N	38,20	37,06	42,0	27,0	-	14,5	22,5	6,0	0,145
	15	ST	6F	0245MR015N	38,20	37,06	42,0	27,0	-	20,5	28,0	6,0	0,180
	25	ST	6F	0245MR025N	38,20	37,06	42,0	27,0	-	30,5	38,0	6,0	0,250
26	9	ST	6F	0265MR009N	41,38	40,24	44,0	30,0	-	14,5	22,5	6,0	0,170
	15	ST	6F	0265MR015N	41,38	40,24	44,0	30,0	-	20,5	28,0	6,0	0,220
	25	ST	6F	0265MR025N	41,38	40,24	44,0	30,0	-	30,5	38,0	6,0	0,300
28	9	ST	6F	0285MR009N	44,56	43,42	48,0	30,5	-	14,5	22,5	6,0	0,200
	15	ST	6F	0285MR015N	44,56	43,42	48,0	30,5	-	20,5	28,0	6,0	0,250
	25	ST	6F	0285MR025N	44,56	43,42	48,0	30,5	-	30,5	38,0	6,0	0,350
30	9	ST	6F	0305MR009N	47,75	46,60	51,0	35,0	-	14,5	22,5	6,0	0,236
	15	ST	6F	0305MR015N	47,75	46,60	51,0	35,0	-	20,5	28,0	6,0	0,300
	25	ST	6F	0305MR025N	47,75	46,60	51,0	35,0	-	30,5	38,0	6,0	0,420
32	9	ST	6F	0325MR009N	50,93	49,79	54,0	38,0	-	14,5	22,5	8,0	0,270
	15	ST	6F	0325MR015N	50,93	49,79	54,0	38,0	-	20,5	28,0	8,0	0,350
	25	ST	6F	0325MR025N	50,93	49,79	54,0	38,0	-	30,5	38,0	8,0	0,480
36	9	ST	6F	0365MR009N	57,30	56,16	60,0	38,0	-	14,5	22,5	8,0	0,324
	15	ST	6F	0365MR015N	57,30	56,16	60,0	38,0	-	20,5	28,0	8,0	0,520
	25	ST	6F	0365MR025N	57,30	56,16	60,0	38,0	-	30,5	38,0	8,0	0,590
40	9	ST	6F	0405MR009N	63,66	62,52	71,00	38,0	-	14,5	22,5	8,0	0,400
	15	ST	6F	0405MR015N	63,66	62,52	71,00	38,0	-	20,5	28,0	8,0	0,426
	25	ST	6F	0405MR025N	63,66	62,52	71,00	38,0	-	30,5	38,0	8,0	0,740

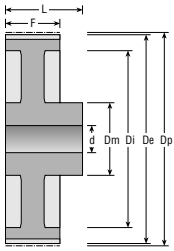

Figur 6W

Z	Rembr. Belt w. Riemenbr.	Mat.	Fig.	Best. nr. Part No. Best. Nr.	Dp	De	Df	Dm	Di	F	L	d	Vægt Weight Gewicht
44	9	AL	6W	0445MR009N	70,03	68,89	-	38,0	-	14,5	25,5	8,0	0,170
	15	AL	6W	0445MR015N	70,03	68,89	-	38,0	-	20,5	30,0	8,0	0,225
	25	AL	6W	0445MR025N	70,03	68,89	-	38,0	-	30,5	40,0	8,0	0,320
48	9	AL	6W	0485MR009N	76,39	75,25	-	45,0	-	14,5	25,5	8,0	0,182
	15	AL	6W	0485MR015N	76,39	75,25	-	38,0	-	20,5	30,0	8,0	0,187
	25	AL	6W	0485MR025N	76,39	75,25	-	38,0	-	30,5	40,0	8,0	0,275
60	9	AL	6W	0605MR009N	95,49	94,35	-	45,0	-	14,5	25,5	8,0	0,230
	15	AL	6W	0605MR015N	95,49	94,35	-	50,0	-	20,5	30,0	8,0	0,305
	25	AL	6W	0605MR025N	95,49	94,35	-	50,0	-	30,5	40,0	8,0	0,435
72	9	AL	6W	0725MR009N	114,59	113,45	-	45,0	-	14,5	25,5	8,0	0,270
	15	AL	6W	0725MR015N	114,59	113,45	-	50,0	-	20,5	30,0	8,0	0,375
	25	AL	6W	0725MR025N	114,59	113,45	-	50,0	-	30,5	40,0	8,0	0,525



B2

8M HTD®-GT®

**FORBORET
WITH PILOT BORE
VORGEBOHRT**

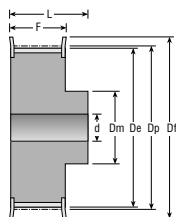

Figur 6F

Z	Rembr. Belt w. Riemenbr.	Mat.	Fig.	Best. nr. Part No. Best. Nr.	Dp	De	Df	Dm	Di	F	L	d	Vægt Weight Gewicht
22	20	ST	6F	0228M020N	56,02	54,65	60,0	43	-	28	38	12	0,54
	30	ST	6F	0228M030N	56,02	54,65	60,0	43	-	38	48	12	0,69
	50	ST	6F	0228M050N	56,02	54,65	60,0	43	-	60	70	12	1,00
	85	ST	6F	0228M085N	56,02	54,65	60,0	43	-	95	105	12	1,55
24	20	ST	6F	0248M020N	61,12	59,75	66,0	45	-	28	38	12	0,65
	30	ST	6F	0248M030N	61,12	59,75	66,0	45	-	38	48	12	0,84
	50	ST	6F	0248M050N	61,12	59,75	66,0	45	-	60	70	12	1,23
	85	ST	6F	0248M085N	61,12	59,75	66,0	45	-	95	105	12	1,90
26	20	ST	6F	0268M020N	66,21	64,84	71,0	50	-	28	38	12	0,80
	30	ST	6F	0268M030N	66,21	64,84	71,0	50	-	38	48	12	1,00
	50	ST	6F	0268M050N	66,21	64,84	71,0	50	-	60	70	12	1,50
	85	ST	6F	0268M085N	66,21	64,84	71,0	50	-	95	105	12	2,25
28	20	ST	6F	0288M020N	71,30	70,08	75,0	50	-	28	38	15	0,87
	30	ST	6F	0288M030N	71,30	70,08	75,0	50	-	38	48	15	1,12
	50	ST	6F	0288M050N	71,30	70,08	75,0	50	-	60	70	15	1,67
	85	ST	6F	0288M085N	71,30	70,08	75,0	50	-	95	105	15	2,55
30	20	ST	6F	0308M020N	76,39	75,13	83,0	55	-	28	38	15	1,02
	30	ST	6F	0308M030N	76,39	75,13	83,0	55	-	38	48	15	1,32
	50	ST	6F	0308M050N	76,39	75,13	83,0	55	-	60	70	15	1,97
	85	ST	6F	0308M085N	76,39	75,13	83,0	55	-	95	105	15	3,00
32	20	ST	6F	0328M020N	81,49	80,16	87,0	60	-	28	38	15	1,20
	30	ST	6F	0328M030N	81,49	80,16	87,0	60	-	38	48	15	1,53
	50	ST	6F	0328M050N	81,49	80,16	87,0	60	-	60	70	15	2,27
	85	ST	6F	0328M085N	81,49	80,16	87,0	60	-	95	105	15	3,57
34	20	ST	6F	0348M020N	86,58	85,22	91,0	70	-	28	38	15	1,40
	30	ST	6F	0348M030N	86,58	85,22	91,0	70	-	38	48	15	1,80
	50	ST	6F	0348M050N	86,58	85,22	91,0	70	-	60	70	15	2,69
	85	ST	6F	0348M085N	86,58	85,22	91,0	70	-	95	105	15	4,00
36	20	ST	6F	0368M020N	91,67	90,30	98,5	70	-	28	38	15	1,55
	30	ST	6F	0368M030N	91,67	90,30	98,5	70	-	38	48	15	1,99
	50	ST	6F	0368M050N	91,67	90,30	98,5	70	-	60	70	15	2,97
	85	ST	6F	0368M085N	91,67	90,30	98,5	70	-	95	105	15	4,50
38	20	ST	6F	0388M020N	96,77	95,39	103,0	75	-	28	38	15	1,65
	30	ST	6F	0388M030N	96,77	95,39	103,0	75	-	38	48	15	2,27
	50	ST	6F	0388M050N	96,77	95,39	103,0	75	-	60	70	15	3,23
	85	ST	6F	0388M085N	96,77	95,39	103,0	75	-	95	105	15	4,90
40	20	GG	6F	0408M020N	101,86	100,49	106,0	75	-	28	38	15	1,74
	30	GG	6F	0408M030N	101,86	100,49	106,0	75	-	38	48	15	2,40
	50	GG	6F	0408M050N	101,86	100,49	106,0	75	-	60	70	18	3,50
	85	GG	6F	0408M085N	101,86	100,49	106,0	75	-	95	105	18	5,20
44	20	GG	6F	0448M020N	112,05	110,67	119,0	75	-	28	38	15	2,10
	30	GG	6F	0448M030N	112,05	110,67	119,0	75	-	38	48	15	2,80
	50	GG	6F	0448M050N	112,05	110,67	119,0	75	-	60	70	18	3,90
	85	GG	6F	0448M085N	112,05	110,67	119,0	75	-	95	105	18	6,60

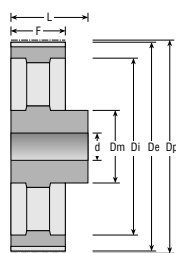

Figur 6A

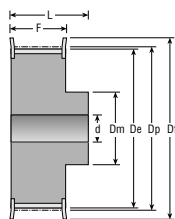

Figur 6F

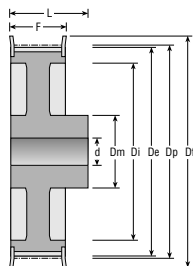

Figur 6WF

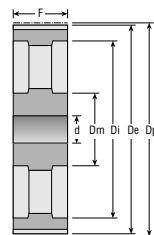

Figur 10A

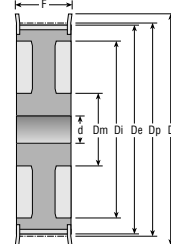

Figur 10WF

Z	Rembr. Belt w. Riemenbr.	Mat.	Fig.	Best. nr. Part No. Best. Nr.	Dp	De	Df	Dm	Di	F	L	d	Vægt Weight Gewicht
48	20	GG	6F	0488M020N	122,23	120,86	127,0	75	-	28	38	15	2,44
	30	GG	6F	0488M030N	122,23	120,86	127,0	75	-	38	48	15	3,20
	50	GG	6F	0488M050N	122,23	120,86	127,0	80	-	60	70	18	4,30
	85	GG	6F	0488M085N	122,23	120,86	127,0	80	-	95	105	18	7,60
56	20	GG	6WF	0568M020N	142,60	141,23	148,0	80	117	28	38	15	2,60
	30	GG	6WF	0568M030N	142,60	141,23	148,0	90	117	38	48	15	3,60
	50	GG	10WF	0568M050N	142,60	141,23	148,0	90	117	60	60	18	5,00
	85	GG	6F	0568M085N	142,60	141,23	148,0	80	-	95	105	20	9,80
64	20	GG	6WF	0648M020N	162,97	161,60	168,0	80	137	28	38	15	2,90
	30	GG	6WF	0648M030N	162,97	161,60	168,0	90	137	38	48	15	4,30
	50	GG	10WF	0648M050N	162,97	161,60	168,0	100	137	60	60	18	5,60
	85	GG	10WF	0648M085N	162,97	161,60	168,0	100	137	95	95	20	10,40
72	20	GG	6WF	0728M020N	183,35	181,97	192,0	80	158	28	38	15	3,10
	30	GG	6WF	0728M030N	183,35	181,97	192,0	95	158	38	48	15	4,80
	50	GG	10WF	0728M050N	183,35	181,97	192,0	100	158	60	60	18	6,80
	85	GG	10WF	0728M085N	183,35	181,97	192,0	110	158	95	95	20	11,40
80	20	GG	6A	0808M020N	203,72	202,35	-	90	180	28	38	15	3,80
	30	GG	6A	0808M030N	203,72	202,35	-	100	180	38	48	15	5,10
	50	GG	10A	0808M050N	203,72	202,35	-	110	180	60	60	18	6,90
	85	GG	10A	0808M085N	203,72	202,35	-	110	180	95	95	20	11,10
90	20	GG	6A	0908M020N	229,18	227,81	-	90	204	28	38	15	4,20
	30	GG	6A	0908M030N	229,18	227,81	-	100	204	38	48	15	5,70
	50	GG	10A	0908M050N	229,18	227,81	-	110	204	60	60	18	8,60
	85	GG	10A	0908M085N	229,18	227,81	-	110	204	95	95	20	13,20
112	20	GG	6A	1128M020N	285,21	283,83	-	90	260	28	38	18	5,20
	30	GG	6A	1128M030N	285,21	283,83	-	100	260	38	48	18	6,80
	50	GG	10A	1128M050N	285,21	283,83	-	110	260	60	60	18	9,60
	85	GG	10A	1128M085N	285,21	283,83	-	110	260	95	95	24	16,30
144	20	GG	6A	1448M020N	366,69	365,32	-	90	341	28	38	20	7,50
	30	GG	6A	1448M030N	366,69	365,32	-	100	341	38	48	20	9,30
	50	GG	10A	1448M050N	366,69	365,32	-	110	341	60	60	20	13,80
	85	GG	10A	1448M085N	366,69	365,32	-	120	341	95	95	24	21,50
168	20	GG	6A	1688M020N	427,81	426,44	-	100	402	28	38	20	10,00
	30	GG	6A	1688M030N	427,81	426,44	-	100	402	38	48	20	11,40
	50	GG	10A	1688M050N	427,81	426,44	-	120	402	60	60	20	16,00
	85	GG	10A	1688M085N	427,81	426,44	-	120	402	95	95	24	26,10
192	20	GG	6A	1928M020N	488,92	487,55	-	100	463	28	38	20	14,40
	30	GG	6A	1928M030N	488,92	487,55	-	100	463	38	48	20	16,00
	50	GG	10A	1928M050N	488,92	487,55	-	130	463	60	60	20	22,40
	85	GG	10A	1928M085N	488,92	487,55	-	130	463	95	95	24	30,60

14M HTD®-GT®

**FORBORET
WITH PILOT BORE
VORGEBOHRT**

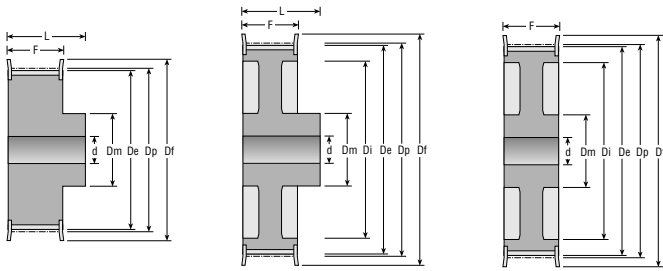

Figur 6F

Figur 6WF

Figur 10WF

Z	Rembr. Belt w. Riemenbr.	Mat.	Fig.	Best. nr. Part No. Best. Nr.	Dp	De	Df	Dm	Di	F	L	d	Vægt Weight Gewicht
28	40	GG	6F	02814M040N	124,78	122,12	127	100	-	54	69	24	4,73
	55	GG	6F	02814M055N	124,78	122,12	127	100	-	70	85	24	5,60
	85	GG	6F	02814M085N	124,78	122,12	127	100	-	102	117	24	7,70
	115	GG	6F	02814M115N	124,78	122,12	127	100	-	133	148	32	9,20
	170	GG	6F	02814M170N	124,78	122,12	127	100	-	187	202	32	13,80
29	40	GG	6F	02914M040N	129,23	126,57	138	100	-	54	69	24	5,09
	55	GG	6F	02914M055N	129,23	126,57	138	100	-	70	85	24	6,10
	85	GG	6F	02914M085N	129,23	126,57	138	100	-	102	117	24	8,40
	115	GG	6F	02914M115N	129,23	126,57	138	100	-	133	148	32	10,20
	170	GG	6F	02914M170N	129,23	126,57	138	100	-	187	202	32	14,20
30	40	GG	6F	03014M040N	133,69	130,99	138	100	-	54	69	24	5,45
	55	GG	6F	03014M055N	133,69	130,99	138	100	-	70	85	24	6,60
	85	GG	6F	03014M085N	133,69	130,99	138	100	-	102	117	24	9,10
	115	GG	6F	03014M115N	133,69	130,99	138	100	-	133	148	32	11,20
	170	GG	6F	03014M170N	133,69	130,99	138	100	-	187	202	32	15,60
32	40	GG	6F	03214M040N	142,60	139,88	154	100	-	54	69	24	6,17
	55	GG	6F	03214M055N	142,60	139,88	154	100	-	70	85	24	7,60
	85	GG	6F	03214M085N	142,60	139,88	154	100	-	102	117	24	10,50
	115	GG	6F	03214M115N	142,60	139,88	154	100	-	133	148	32	13,20
	170	GG	6F	03214M170N	142,60	139,88	154	100	-	187	202	32	18,10
34	40	GG	6F	03414M040N	151,52	148,79	160	100	-	54	69	24	6,88
	55	GG	6F	03414M055N	151,52	148,79	160	100	-	70	85	24	8,60
	85	GG	6F	03414M085N	151,52	148,79	160	100	-	102	117	24	11,90
	115	GG	6F	03414M115N	151,52	148,79	160	100	-	133	148	32	14,80
	170	GG	6F	03414M170N	151,52	148,79	160	100	-	187	202	32	20,40
36	40	GG	6F	03614M040N	160,43	157,68	168	100	-	54	69	24	7,60
	55	GG	6F	03614M055N	160,43	157,68	168	100	-	70	85	24	9,60
	85	GG	6F	03614M085N	160,43	157,68	168	100	-	102	117	32	13,20
	115	GG	6F	03614M115N	160,43	157,68	168	120	-	133	148	32	16,60
	170	GG	6F	03614M170N	160,43	157,68	168	120	-	187	202	32	23,50
38	40	GG	6F	03814M040N	169,34	166,60	183	120	-	54	69	24	8,28
	55	GG	6F	03814M055N	169,34	166,60	183	120	-	70	85	24	10,80
	85	GG	6F	03814M085N	169,34	166,60	183	120	-	102	117	32	15,15
	115	GG	6F	03814M115N	169,34	166,60	183	120	-	133	148	32	19,20
	170	GG	6F	03814M170N	169,34	166,60	183	135	-	187	202	32	26,50
40	40	GG	6F	04014M040N	178,25	175,49	188	120	-	54	69	24	9,26
	55	GG	6F	04014M055N	178,25	175,49	188	120	-	70	85	24	11,20
	85	GG	6F	04014M085N	178,25	175,49	188	135	-	102	117	32	17,10
	115	GG	6F	04014M115N	178,25	175,49	188	135	-	133	148	32	20,56
	170	GG	6F	04014M170N	178,25	175,49	188	140	-	187	202	32	30,10
44	40	GG	6F	04414M040N	196,08	193,28	211	120	-	54	69	24	10,32
	55	GG	6F	04414M055N	196,08	193,28	211	120	-	70	85	24	12,50
	85	GG	6F	04414M085N	196,08	193,28	211	135	-	102	117	32	23,30
	115	GG	6F	04414M115N	196,08	193,28	211	140	-	133	148	32	28,00
	170	GG	6F	04414M170N	196,08	193,28	211	160	-	187	202	32	37,80
48	40	GG	6WF	04814M040N	213,90	211,11	226	135	172	54	69	24	11,50
	55	GG	10WF	04814M055N	213,90	211,11	226	135	172	70	70	24	13,70
	85	GG	6F	04814M085N	213,90	211,11	226	150	-	102	117	32	25,00
	115	GG	6F	04814M115N	213,90	211,11	226	150	-	133	148	32	35,00
	170	GG	6F	04814M170N	213,90	211,11	226	160	-	187	202	32	44,50

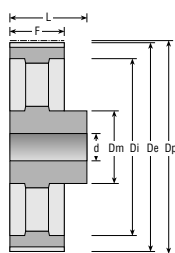

Figur 6A

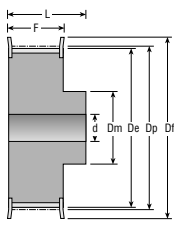

Figur 6F

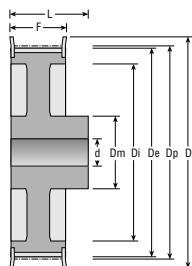

Figur 6WF

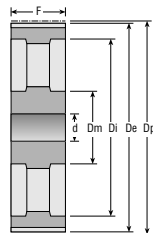

Figur 10A

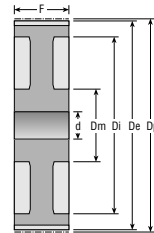

Figur 10W

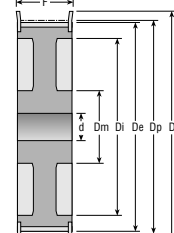

Figur 10WF

Z	Rembr. Belt w. Riemenbr.	Mat.	Fig.	Best. nr. Part No. Best. Nr.	Dp	De	Df	Dm	Di	F	L	d	Vægt Weight Gewicht
56	40	GG	6WF	05614M040N	249,55	246,76	256	135	207	54	69	28	13,05
	55	GG	10WF	05614M055N	249,55	246,76	256	135	207	70	70	28	14,50
	85	GG	10WF	05614M085N	249,55	246,76	256	150	207	102	102	32	25,00
	115	GG	6F	05614M115N	249,55	246,76	256	150	-	133	148	32	27,50
	170	GG	6F	05614M170N	249,55	246,76	256	160	-	187	202	32	61,00
64	40	GG	6WF	06414M040N	285,21	282,41	296	135	242	54	69	28	14,40
	55	GG	10WF	06414M055N	285,21	282,41	296	135	242	70	70	28	15,60
	85	GG	10WF	06414M085N	285,21	282,41	296	150	242	102	102	32	28,20
	115	GG	10WF	06414M115N	285,21	282,41	296	150	242	133	133	32	36,80
	170	GG	6F	06414M170N	285,21	282,41	296	180	-	187	202	32	81,00
72	40	GG	6A	07214M040N	320,86	318,06	-	135	278	54	69	28	16,90
	55	GG	10A	07214M055N	320,86	318,06	-	135	278	70	70	28	18,50
	85	GG	10A	07214M085N	320,86	318,06	-	150	278	102	102	32	28,80
	115	GG	10A	07214M115N	320,86	318,06	-	150	278	133	133	32	32,83
	170	GG	10W	07214M170N	320,86	318,06	-	180	278	187	187	32	61,40
80	40	GG	6A	08014M040N	356,51	353,71	-	135	314	54	69	28	18,50
	55	GG	10A	08014M055N	356,51	353,71	-	135	314	70	70	28	20,00
	85	GG	10A	08014M085N	356,51	353,71	-	150	314	102	102	32	30,10
	115	GG	10A	08014M115N	356,51	353,71	-	150	314	133	133	32	35,55
	170	GG	10W	08014M170N	356,51	353,71	-	180	314	187	187	32	65,00
90	40	GG	6A	09014M040N	401,07	398,28	-	135	358	54	69	28	20,00
	55	GG	10A	09014M055N	401,07	398,28	-	135	358	70	70	28	22,60
	85	GG	10A	09014M085N	401,07	398,28	-	150	358	102	102	32	33,00
	115	GG	10A	09014M115N	401,07	398,28	-	150	358	133	133	32	41,00
	170	GG	10A	09014M170N	401,07	398,28	-	180	358	187	187	38	68,00
112	40	GG	6A	11214M040N	499,11	496,32	-	135	456	54	69	28	26,70
	55	GG	10A	11214M055N	499,11	496,32	-	135	456	70	70	28	29,50
	85	GG	10A	11214M085N	499,11	496,32	-	150	456	102	102	32	41,80
	115	GG	10A	11214M115N	499,11	496,32	-	150	456	133	133	32	54,40
	170	GG	10A	11214M170N	499,11	496,32	-	200	456	187	187	38	87,50
144	40	GG	6A	14414M040N	641,71	638,92	-	135	600	54	69	28	35,00
	55	GG	10A	14414M055N	641,71	638,92	-	135	600	70	70	28	39,00
	85	GG	10A	14414M085N	641,71	638,92	-	150	600	102	102	32	52,40
	115	GG	10A	14414M115N	641,71	638,92	-	165	600	133	133	32	67,80
	170	GG	10A	14414M170N	641,71	638,92	-	220	600	187	187	38	114,80
168	40	GG	6A	16814M040N	748,66	745,87	-	135	706	54	69	28	44,20
	55	GG	10A	16814M055N	748,66	745,87	-	135	706	70	70	28	48,50
	85	GG	10A	16814M085N	748,66	745,87	-	150	706	102	102	32	60,30
	115	GG	10A	16814M115N	748,66	745,87	-	165	706	133	133	32	75,80
	170	GG	10A	16814M170N	748,66	745,87	-	220	706	187	187	38	125,00
192	40	GG	6A	19214M040N	855,62	852,82	-	135	813	54	69	28	52,20
	55	GG	10A	19214M055N	855,62	852,82	-	135	813	70	70	28	57,80
	85	GG	10A	19214M085N	855,62	852,82	-	165	813	102	102	32	70,20
	115	GG	10A	19214M115N	855,62	852,82	-	165	813	133	133	32	88,30
	170	GG	10A	19214M170N	855,62	852,82	-	220	813	187	187	38	136,40
216	40	GG	6A	21614M040N	962,57	959,76	-	150	920	54	69	28	60,00
	55	GG	10A	21614M055N	962,57	959,76	-	150	920	70	70	28	67,00
	85	GG	10A	21614M085N	962,57	959,76	-	165	920	102	102	32	81,00
	115	GG	10A	21614M115N	962,57	959,76	-	165	920	133	133	32	98,00
	170	GG	10A	21614M170N	962,57	959,76	-	220	920	187	187	38	147,00



XL

B2

1/5" (5,08 mm)

FORBORET WITH PILOT BORE VORGEBOHRT

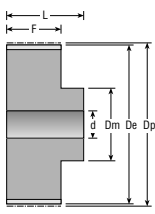

Figur 6

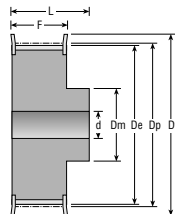

Figur 6F

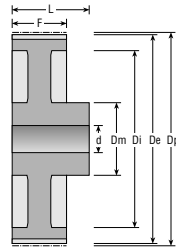

Figur 6W

Z	Rembr. Belt w. Riemenbr.	Mat.	Fig.	Best. nr. Part No. Best. Nr.	Dp	De	Df	Dm	F	L	d	Max. udbor. Max bore Max. Bohr.	Vægt Weight Gewicht
10	37	ST	6F	010XL037N	16,17	15,66	23	9,5	14,3	19,8	5	6,4	0,02
	37	AL	6F	010XL037A	16,17	15,66	23	9,5	14,3	19,8	5	6,4	
11	37	ST	6F	011XL037N	17,79	17,28	23	9,5	14,3	19,8	5	6,4	0,02
	37	AL	6F	011XL037A	17,79	17,28	23	9,5	14,3	19,8	5	6,4	
12	37	ST	6F	012XL037N	19,40	18,90	25	12,7	14,3	19,8	5	7,9	0,03
	37	AL	6F	012XL037A	19,40	18,90	25	12,7	14,3	19,8	5	7,9	
14	37	ST	6F	014XL037N	22,64	22,13	28	14,3	14,3	19,8	6	9,5	0,04
	37	AL	6F	014XL037A	22,64	22,13	28	14,3	14,3	19,8	6	9,5	
15	37	ST	6F	015XL037N	24,26	23,75	28	15,9	14,3	19,8	6	11,1	0,04
	37	AL	6F	015XL037A	24,26	23,75	28	15,9	14,3	19,8	6	11,1	
16	37	ST	6F	016XL037N	25,87	25,36	32	17,5	14,3	19,8	6	12,7	0,05
	37	AL	6F	016XL037A	25,87	25,36	32	17,5	14,3	19,8	6	12,7	
18	37	ST	6F	018XL037N	29,11	28,60	36	19,0	14,3	19,8	6	14,3	0,06
	37	AL	6F	018XL037A	29,11	28,60	36	19,0	14,3	19,8	6	14,3	
19	37	ST	6F	019XL037N	30,72	30,21	36	20,0	14,3	19,8	6	14,5	0,08
20	37	ST	6F	020XL037N	32,34	31,83	38	23,8	14,3	22,2	6	17,5	0,08
	37	AL	6F	020XL037A	32,34	31,83	38	23,8	14,3	22,2	6	17,5	
21	37	ST	6F	021XL037N	33,96	33,45	38	23,8	14,3	22,2	6	17,5	0,09
	37	AL	6F	021XL037A	33,96	33,45	38	23,8	14,3	22,2	6	17,5	
22	37	ST	6F	022XL037N	35,57	35,07	42	25,4	14,3	22,2	6	19,1	0,10
	37	AL	6F	022XL037A	35,57	35,07	42	25,4	14,3	22,2	6	19,1	
24	37	ST	6F	024XL037N	38,81	38,30	44	27,0	14,3	22,2	6	20,6	0,12
	37	AL	6F	024XL037A	38,81	38,30	44	27,0	14,3	22,2	6	20,6	
26	37	ST	6F	026XL037N	42,04	41,53	48	30,0	14,3	22,2	6	23,0	0,14
	37	AL	6F	026XL037A	42,04	41,53	48	30,0	14,3	22,2	6	23,0	
28	37	ST	6F	028XL037N	45,28	44,77	51	30,2	14,3	22,2	6	23,0	0,16
	37	AL	6F	028XL037A	45,28	44,77	51	30,2	14,3	22,2	6	23,0	
30	37	ST	6F	030XL037N	48,51	48,00	54	34,9	14,3	22,2	6	23,0	0,19
	37	AL	6F	030XL037A	48,51	48,00	54	34,9	14,3	22,2	6	23,0	
32	37	AL	6	032XL037N	51,74	51,24	-	38,0	14,3	25,4	8	23,0	0,11
36	37	AL	6	036XL037N	58,21	57,70	-	38,0	14,3	25,4	8	23,0	0,13
40	37	AL	6	040XL037N	64,68	64,17	-	38,0	14,3	25,4	8	23,0	0,17
42	37	AL	6W	042XL037N	67,91	67,41	-	38,0	14,3	25,4	8	23,0	0,13
44	37	AL	6W	044XL037N	71,15	70,64	-	38,0	14,3	25,4	8	23,0	0,15
48	37	AL	6W	048XL037N	77,62	77,11	-	38,0	14,3	25,4	8	23,0	0,16
60	37	AL	6W	060XL037N	97,02	96,51	-	38,0	14,3	25,4	8	23,0	0,18
72	37	AL	6W	072XL037N	116,43	115,92	-	38,0	14,3	25,4	8	23,0	0,23

FORBORET
WITH PILOT BORE
VORGEBOHRT

L



B2

3/8" (9,525 mm)

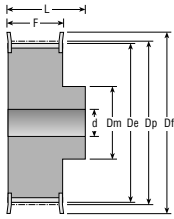

Figur 6F

Z	Rembr. Belt w. Riemenbr.	Mat.	Fig.	Best. nr. Part No. Best. Nr.	Dp	De	Df	Dm	F	L	E	d	Max. udbor. Max bore Max. Bohr.	Vægt Weight Gewicht
10	50	ST	6F	010L050N	30,32	29,59	36	22	19	26	-	6	13	0,11
	75	ST	6F	010L075N	30,32	29,59	36	22	25	32	-	6	13	0,15
	100	ST	6F	010L100N	30,32	29,59	36	22	31	38	-	6	13	0,18
12	50	ST	6F	012L050N	36,38	35,62	42	28	19	26	-	6	17	0,19
	75	ST	6F	012L075N	36,38	35,62	42	28	25	32	-	8	17	0,23
	100	ST	6F	012L100N	36,38	35,62	42	28	31	38	-	8	17	0,29
13	50	ST	6F	013L050N	39,41	38,65	44	30	19	26	-	6	19	0,21
	75	ST	6F	013L075N	39,41	38,65	44	30	25	32	-	8	19	0,26
	100	ST	6F	013L100N	39,41	38,65	44	30	31	38	-	8	19	0,30
14	50	ST	6F	014L050N	42,45	41,68	48	33	19	26	-	8	20	0,25
	75	ST	6F	014L075N	42,45	41,68	48	33	25	32	-	8	20	0,32
	100	ST	6F	014L100N	42,45	41,68	48	33	31	38	-	8	20	0,38
15	50	ST	6F	015L050N	45,48	44,72	51	36	19	26	-	8	23	0,30
	75	ST	6F	015L075N	45,48	44,72	51	36	25	32	-	8	23	0,35
	100	ST	6F	015L100N	45,48	44,72	51	36	31	38	-	8	23	0,40
16	50	ST	6F	016L050N	48,51	47,75	54	38	19	26	-	8	23	0,33
	75	ST	6F	016L075N	48,51	47,75	54	38	25	32	-	8	23	0,42
	100	ST	6F	016L100N	48,51	47,75	54	38	31	38	-	8	23	0,51
17	50	ST	6F	017L050N	51,54	50,78	57	40	19	26	-	10	24	0,36
	75	ST	6F	017L075N	51,54	50,78	57	40	25	32	-	10	24	0,45
	100	ST	6F	017L100N	51,54	50,78	57	40	31	38	-	10	24	0,54
18	50	ST	6F	018L050N	54,57	53,81	60	40	19	26	-	10	24	0,41
	75	ST	6F	018L075N	54,57	53,81	60	40	25	32	-	10	24	0,51
	100	ST	6F	018L100N	54,57	53,81	60	40	31	38	-	10	24	0,62
19	50	ST	6F	019L050N	57,61	56,84	60	40	19	26	-	10	24	0,45
	75	ST	6F	019L075N	57,61	56,84	60	40	25	32	-	10	24	0,57
	100	ST	6F	019L100N	57,61	56,84	60	40	31	38	-	10	24	0,69
20	50	ST	6F	020L050N	60,64	59,88	66	46	19	26	-	10	28	0,50
	75	ST	6F	020L075N	60,64	59,88	66	46	25	32	-	10	28	0,63
	100	ST	6F	020L100N	60,64	59,88	66	46	31	38	-	10	28	0,76
21	50	ST	6F	021L050N	63,67	62,91	71	46	19	26	-	10	28	0,55
	75	ST	6F	021L075N	63,67	62,91	71	46	25	32	-	10	28	0,70
	100	ST	6F	021L100N	63,67	62,91	71	46	31	38	-	10	28	0,82
22	50	ST	6F	022L050N	66,70	65,94	75	50	19	26	-	10	30	0,62
	75	ST	6F	022L075N	66,70	65,94	75	50	25	32	-	10	30	0,75
	100	ST	6F	022L100N	66,70	65,94	75	50	31	38	-	10	30	0,92
24	50	ST	6F	024L050N	72,77	72,00	79	50	19	26	-	12	30	0,68
	75	ST	6F	024L075N	72,77	72,00	79	50	25	32	-	12	30	0,85
	100	ST	6F	024L100N	72,77	72,00	79	50	31	38	-	12	30	1,10
26	50	ST	6F	026L050N	78,83	78,07	87	50	19	26	-	12	30	0,82
	75	ST	6F	026L075N	78,83	78,07	87	50	25	32	-	12	30	1,00
	100	ST	6F	026L100N	78,83	78,07	87	50	31	38	-	12	30	1,30
28	50	ST	6F	028L050N	84,89	84,13	91	50	19	26	-	12	30	0,92
	75	ST	6F	028L075N	84,89	84,13	91	50	25	32	-	12	30	1,20
	100	ST	6F	028L100N	84,89	84,13	91	50	31	38	-	12	30	1,40

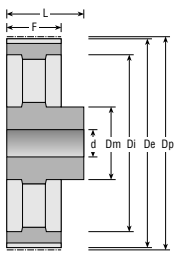
**B2****L****3/8" (9,525 mm)****FORBORET
WITH PILOT BORE
VORGEBOHRT**

Figur 6A

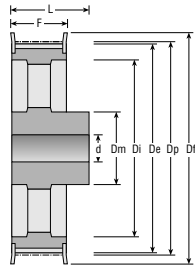

Figur 6AF

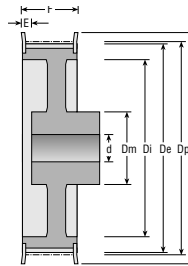

Figur 6CWF

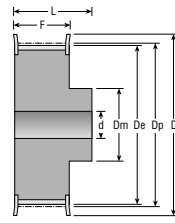

Figur 6F

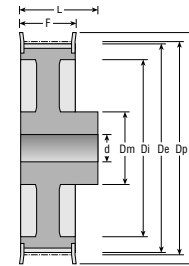

Figur 6WF

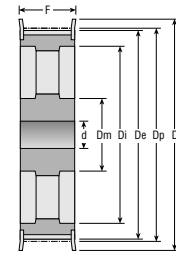

Figur 10AF

Z	Rembr. Belt w. Riemenbr.	Mat.	Fig.	Best. nr. Part No. Best. Nr.	Dp	De	Df	Dm	F	L	E	d	Max. udbor. Max bore Max. Bohr.	Vægt Weight Gewicht
30	50	ST	6F	030L050N	90,96	90,20	97	50	19	26	-	12	30	1,10
	75	ST	6F	030L075N	90,96	90,20	97	50	25	32	-	12	30	1,40
	100	ST	6F	030L100N	90,96	90,20	97	50	31	38	-	12	30	1,70
32	50	ST	6F	032L050N	97,02	96,26	103	50	19	26	-	12	30	1,20
	75	ST	6F	032L075N	97,02	96,26	103	50	25	32	-	12	30	1,50
	100	ST	6F	032L100N	97,02	96,26	103	50	31	38	-	12	30	1,80
36	50	GG	6WF	036L050N	109,15	108,39	115	50	19	26	-	12	30	1,00
	75	GG	6WF	036L075N	109,15	108,39	115	55	25	32	-	12	32	1,30
	100	GG	6CWF	036L100N	109,15	108,39	115	55	32	32	6	12	32	1,50
40	50	GG	6WF	040L050N	121,28	120,51	127	50	19	26	-	12	30	1,10
	75	GG	6WF	040L075N	121,28	120,51	127	60	25	32	-	12	35	1,60
	100	GG	6CWF	040L100N	121,28	120,51	127	60	32	32	6	12	35	1,80
44	50	GG	6AF	044L050N	133,40	132,64	140	50	19	26	-	12	30	1,20
	75	GG	6AF	044L075N	133,40	132,64	140	60	25	32	-	12	35	1,70
	100	GG	10AF	044L100N	133,40	132,64	140	60	32	-	-	12	35	1,90
48	50	GG	6AF	048L050N	145,53	144,77	152	50	19	26	-	12	30	1,30
	75	GG	6AF	048L075N	145,53	144,77	152	60	25	32	-	12	35	1,90
	100	GG	10AF	048L100N	145,53	144,77	152	60	32	-	-	12	35	2,10
60	50	GG	6A	060L050N	181,91	181,15	-	50	19	28	-	15	30	1,30
	75	GG	6A	060L075N	181,91	181,15	-	60	26	35	-	15	35	1,80
	100	GG	6A	060L100N	181,91	181,15	-	60	32	35	-	15	35	2,00
72	50	GG	6A	072L050N	218,30	217,53	-	50	19	28	-	15	30	1,70
	75	GG	6A	072L075N	218,30	217,53	-	60	26	35	-	15	35	2,30
	100	GG	6A	072L100N	218,30	217,53	-	60	32	35	-	15	35	2,50
84	50	GG	6A	084L050N	254,68	253,92	-	50	19	28	-	15	30	1,90
	75	GG	6A	084L075N	254,68	253,92	-	60	29	35	-	15	35	2,50
	100	GG	6A	084L100N	254,68	253,92	-	60	32	35	-	15	35	2,70

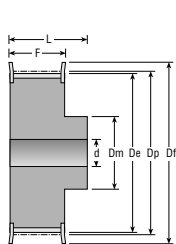

Figur 6F

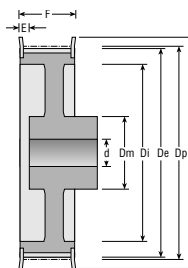

Figur 6CWF

Z	Rembr. Belt w. Riemenbr.	Mat.	Fig.	Best. nr. Part No. Best. Nr.	Dp	De	Df	Dm	F	L	E	d	Max. udbor. Max bore Max. Bohr.	Vægt Weight Gewicht
14	075	ST	6F	014H075N	56,60	55,22	64	40	26,4	40	-	10	24	0,50
	100	ST	6F	014H100N	56,60	55,22	63	40	31	41	-	10	24	0,65
	150	ST	6F	014H150N	56,60	55,22	63	40	44	54	-	12	24	0,82
	200	ST	6F	014H200N	56,60	55,22	63	40	58	68	-	12	24	1,10
16	075	ST	6F	016H075N	64,68	63,31	70	46	26,4	40	-	10	28	0,60
	100	ST	6F	016H100N	64,68	63,31	71	46	31	41	-	10	28	0,85
	150	ST	6F	016H150N	64,68	63,31	71	46	44	54	-	12	28	1,10
	200	ST	6F	016H200N	64,68	63,31	71	46	58	68	-	15	28	1,40
	300	ST	6F	016H300N	64,68	63,31	71	46	84	94	-	15	28	2,00
18	075	ST	6F	018H075N	72,77	71,39	79	54	26,4	40	-	12	32	0,80
	100	ST	6F	018H100N	72,77	71,39	79	54	31	41	-	12	32	1,10
	150	ST	6F	018H150N	72,77	71,39	79	54	44	54	-	12	32	1,50
	200	ST	6F	018H200N	72,77	71,39	79	54	58	68	-	15	32	1,80
	300	ST	6F	018H300N	72,77	71,39	79	54	84	94	-	15	32	2,60
19	075	ST	6F	019H075N	76,81	75,44	82,5	58	26,4	40	-	12	34	1,00
	100	ST	6F	019H100N	76,81	75,44	82	58	31	41	-	12	34	1,20
	150	ST	6F	019H150N	76,81	75,44	82	58	44	54	-	12	34	1,70
	200	ST	6F	019H200N	76,81	75,44	82	58	58	68	-	15	34	2,10
	300	ST	6F	019H300N	76,81	75,44	82	58	84	94	-	15	34	2,90
20	075	ST	6F	020H075N	80,85	79,48	87	62	26,4	40	-	12	35	1,10
	100	ST	6F	020H100N	80,85	79,48	87	62	31	41	-	12	35	1,40
	150	ST	6F	020H150N	80,85	79,48	87	62	44	54	-	12	35	1,80
	200	ST	6F	020H200N	80,85	79,48	87	62	58	68	-	15	35	2,30
	300	ST	6F	020H300N	80,85	79,48	87	62	84	94	-	15	35	3,20
21	075	ST	6F	021H075N	84,89	83,52	91	67	26,4	40	-	12	38	1,20
	100	ST	6F	021H100N	84,89	83,52	91	67	31	41	-	12	38	1,60
	150	ST	6F	021H150N	84,89	83,52	91	67	44	54	-	12	38	2,20
	200	ST	6F	021H200N	84,89	83,52	91	67	58	68	-	15	38	2,60
	300	ST	6F	021H300N	84,89	83,52	91	67	84	94	-	15	38	3,60
22	075	ST	6F	022H075N	88,94	87,56	94	70	26,4	40	-	12	41	1,40
	100	ST	6F	022H100N	88,94	87,56	93	70	31	41	-	12	41	1,70
	150	ST	6F	022H150N	88,94	87,56	93	70	44	54	-	12	41	2,30
	200	ST	6F	022H200N	88,94	87,56	93	70	58	68	-	15	41	2,80
	300	ST	6F	022H300N	88,94	87,56	93	70	84	94	-	15	41	4,00
24	075	ST	6F	024H075N	97,02	95,65	102	75	26,4	40	-	12	45	1,60
	100	ST	6F	024H100N	97,02	95,65	103	75	31	41	-	12	45	2,00
	150	ST	6F	024H150N	97,02	95,65	103	75	44	54	-	12	45	2,60
	200	ST	6F	024H200N	97,02	95,65	103	75	58	68	-	15	45	3,40
	300	ST	6F	024H300N	97,02	95,65	103	75	84	94	-	15	45	4,70
26	075	ST	6F	026H075N	105,11	103,73	112	80	26,4	40	-	15	45	1,80
	100	GG	6CWF	026H100N	105,11	103,73	111	55	32	32	8	15	32	1,40
	150	GG	6CWF	026H150N	105,11	103,73	111	55	45	35	18	15	32	1,70
	200	GG	6CWF	026H200N	105,11	103,73	111	60	58	42	24	15	35	2,30
	300	GG	6CWF	026H300N	105,11	103,73	111	60	84	57	35	15	35	3,30



H

B2

1/2" (12,7 mm)

FORBØRET WITH PILOT BORE VORGEBOHRT

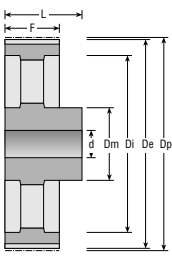

Figur 6A

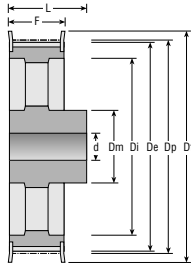

Figur 6AF

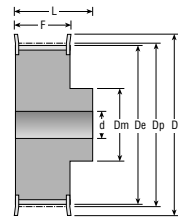

Figur 6F

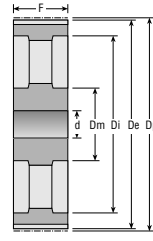

Figur 10A

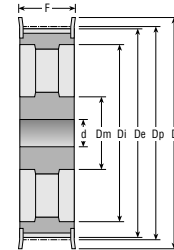

Figur 10AF

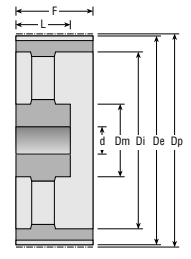

Figur 11A

Z	Rembr. Belt w. Riemenbr.	Mat.	Fig.	Best. nr. Part No. Best. Nr.	Dp	De	Df	Dm	F	L	E	d	Max. udbor. Max bore Max. Bohr.	Vægt Weight Gewicht
28	075	GG	6F	028H075N	113,19	111,82	120	80	26,4	40	-	15	45	2,00
	100	GG	6CWF	028H100N	113,19	111,82	119	60	32	32	8	15	35	1,60
	150	GG	6CWF	028H150N	113,19	111,82	119	60	45	35	18	15	35	1,90
	200	GG	6CWF	028H200N	113,19	111,82	119	60	58	42	24	15	35	2,50
	300	GG	6CWF	028H300N	113,19	111,82	119	60	84	57	35	15	35	3,60
30	075	GG	6F	030H075N	121,28	119,90	128	80	26,4	40	-	15	45	2,10
	100	GG	6CWF	030H100N	121,28	119,90	127	60	32	32	8	15	35	1,70
	150	GG	6CWF	030H150N	121,28	119,90	127	60	45	35	18	15	35	2,10
	200	GG	6CWF	030H200N	121,28	119,90	127	70	58	42	24	15	40	2,90
	300	GG	6CWF	030H300N	121,28	119,90	127	70	84	57	35	15	40	4,20
32	075	GG	6F	032H075N	129,36	127,99	135	70	27	40	15	15	40	2,20
	100	GG	6WF	032H100N	129,36	127,99	135	70	32	40	-	20	40	2,20
	150	GG	6CWF	032H150N	129,36	127,99	135	70	45	45	8	20	40	2,60
	200	GG	6CWF	032H200N	129,36	127,99	135	70	58	47	19	20	40	3,20
	300	GG	6CWF	032H300N	129,36	127,99	135	70	84	57	35	20	40	4,30
36	075	GG	6F	036H075N	145,53	144,16	152	80	26,4	40	-	20	45	2,40
	100	GG	6WF	036H100N	145,53	144,16	152	80	32	40	-	20	45	3,00
	150	GG	6CWF	036H150N	145,53	144,16	152	80	45	45	8	20	45	3,20
	200	GG	6CWF	036H200N	145,53	144,16	152	80	58	47	19	20	45	3,80
	300	GG	6CWF	036H300N	145,53	144,16	152	80	84	57	35	20	45	5,20
40	075	GG	6F	040H075N	161,70	160,33	168	80	26,4	40	-	20	45	2,80
	100	GG	6AF	040H100N	161,70	160,33	168	80	32	40	-	20	45	2,80
	150	GG	10AF	040H150N	161,70	160,33	168	80	45	-	-	20	45	3,80
	200	GG	11AF	040H200N	161,70	160,33	168	80	58	45	-	20	45	4,10
	300	GG	11AF	040H300N	161,70	160,33	168	80	84	55	-	20	45	5,60
44	075	GG	6AF	044H075N	177,87	176,50	184	80	26,4	40	-	20	45	2,70
	100	GG	6AF	044H100N	177,87	176,50	184	80	32	40	-	20	45	3,10
	150	GG	10AF	044H150N	177,87	176,50	184	80	45	-	-	20	45	3,70
	200	GG	11AF	044H200N	177,87	176,50	184	80	58	45	-	20	45	4,40
	300	GG	11AF	044H300N	177,87	176,50	184	80	84	55	-	20	45	5,90
48	075	GG	6AF	048H075N	194,04	192,67	200	90	26,4	40	-	20	45	3,00
	100	GG	6AF	048H100N	194,04	192,67	200	80	32	40	-	20	45	3,30
	150	GG	10AF	048H150N	194,04	192,67	200	80	45	-	-	20	45	4,00
	200	GG	11AF	048H200N	194,04	192,67	200	85	58	45	-	20	48	5,10
	300	GG	11AF	048H300N	194,04	192,67	200	85	84	55	-	20	48	6,60
60	100	GG	6A	060H100N	242,55	241,18	-	80	34	45	-	20	45	5,50
	150	GG	10A	060H150N	242,55	241,18	-	85	46	-	-	20	48	5,10
	200	GG	11A	060H200N	242,55	241,18	-	90	60	50	-	20	50	7,10
	300	GG	11A	060H300N	242,55	241,18	-	100	86	55	-	20	57	9,90
72	100	GG	6A	072H100N	291,06	289,69	-	80	34	45	-	20	45	7,10
	150	GG	10A	072H150N	291,06	289,69	-	85	46	-	-	20	48	7,90
	200	GG	11A	072H200N	291,06	289,69	-	90	60	50	-	20	50	8,00
	300	GG	11A	072H300N	291,06	289,69	-	100	86	55	-	20	57	13,00

**FORBORET
WITH PILOT BORE
VORGEBOHRT**

H



1/2" (12,7 mm)

B2

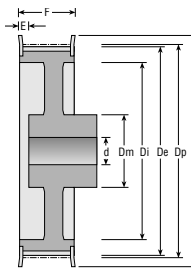

Figur 6CWF

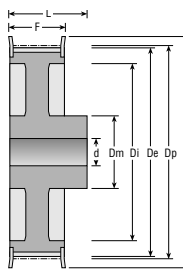

Figur 6WF

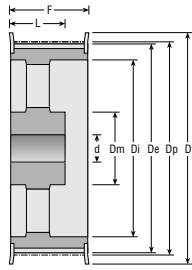

Figur 11AF

Z	Rembr. Belt w. Riemenbr.	Mat.	Fig.	Best. nr. Part No. Best. Nr.	Dp	De	Df	Dm	F	L	E	d	Max. udbor. Max bore Max. Bohr.	Vægt Weight Gewicht
84	100	GG	6A	084H100N	339,57	338,20	-	80	34	45	-	20	45	8,20
	150	GG	10A	084H150N	339,57	338,20	-	85	46	-	-	20	48	8,90
	200	GG	11A	084H200N	339,57	338,20	-	90	60	50	-	20	50	12,00
	300	GG	11A	084H300N	339,57	338,20	-	100	86	55	-	20	57	15,10
96	100	GG	6A	096H100N	388,08	386,71	-	80	34	45	-	20	45	9,90
	150	GG	10A	096H150N	388,08	386,71	-	85	46	-	-	20	48	10,10
	200	GG	11A	096H200N	388,08	386,71	-	90	60	50	-	20	50	13,60
	300	GG	11A	096H300N	388,08	386,71	-	100	86	55	-	20	57	18,20
120	100	GG	6A	120H100N	485,10	483,73	-	90	34	50	-	20	50	13,10
	150	GG	6A	120H150N	485,10	483,73	-	95	46	55	-	24	55	17,20
	200	GG	11A	120H200N	485,10	483,73	-	100	60	-	-	24	57	16,60
	300	GG	11A	120H300N	485,10	483,73	-	110	86	65	-	24	62	26,00

**B2**

T 2,5

2,5 mm

FORBORET WITH PILOT BORE VORGEBOHRT

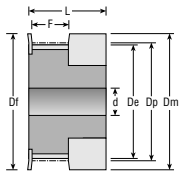

Figur 1F

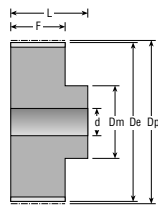

Figur 6

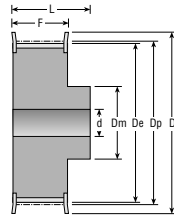

Figur 6F

Z	Rembr. Belt w. Riemenbr.	Mat.	Fig.	Best. nr. Part No. Best. Nr.	De	Df	Dm	F	L	d	Vægt Weight Gewicht
12	4	AL	1F	16T2,5012N	9,00	13,0	12	9	16	-	0,003
	6	AL	1F	16T2,5012N	9,00	13,0	12	9	16	-	0,003
14	4	AL	1F	16T2,5014N	10,60	15,0	14	9	16	-	0,004
	6	AL	1F	16T2,5014N	10,60	15,0	14	9	16	-	0,004
15	4	AL	1F	16T2,5015N	11,40	15,0	15	9	16	-	0,005
	6	AL	1F	16T2,5015N	11,40	15,0	15	9	16	-	0,005
16	4	AL	1F	16T2,5016N	12,20	16,0	16	9	16	-	0,005
	6	AL	1F	16T2,5016N	12,20	16,0	16	9	16	-	0,005
18	4	AL	6F	16T2,5018N	13,80	17,5	9,5	10	16	4	0,006
	6	AL	6F	16T2,5018N	13,80	17,5	9,5	10	16	4	0,006
19	4	AL	6F	16T2,5019N	14,60	18,0	9,5	10	16	4	0,007
	6	AL	6F	16T2,5019N	14,60	18,0	9,5	10	16	4	0,007
20	4	AL	6F	16T2,5020N	15,40	19,5	10	10	16	4	0,008
	6	AL	6F	16T2,5020N	15,40	19,5	10	10	16	4	0,008
22	4	AL	6F	16T2,5022N	17,00	23,0	10	10	16	4	0,009
	6	AL	6F	16T2,5022N	17,00	23,0	10	10	16	4	0,009
25	4	AL	6F	16T2,5025N	19,35	23,0	12	10	16	4	0,013
	6	AL	6F	16T2,5025N	19,35	23,0	12	10	16	4	0,013
26	4	AL	6F	16T2,5026N	20,15	25,0	13	10	16	4	0,014
	6	AL	6F	16T2,5026N	20,15	25,0	13	10	16	4	0,014
28	4	AL	6F	16T2,5028N	21,75	25,0	13	10	16	4	0,016
	6	AL	6F	16T2,5028N	21,75	25,0	13	10	16	4	0,016
30	4	AL	6F	16T2,5030N	23,35	28,0	16	10	16	6	0,018
	6	AL	6F	16T2,5030N	23,35	28,0	16	10	16	6	0,018
32	4	AL	6F	16T2,5032N	24,95	32,0	16	10	16	6	0,020
	6	AL	6F	16T2,5032N	24,95	32,0	16	10	16	6	0,020
36	4	AL	6F	16T2,5036N	28,10	36,0	20	10	16	6	0,026
	6	AL	6F	16T2,5036N	28,10	36,0	20	10	16	6	0,026
40	4	AL	6F	16T2,5040N	31,30	38,0	20	10	16	6	0,032
	6	AL	6F	16T2,5040N	31,30	38,0	20	10	16	6	0,032
44	4	AL	6F	16T2,5044N	34,50	42,0	24	10	16	6	0,040
	6	AL	6F	16T2,5044N	34,50	42,0	24	10	16	6	0,040
48	4	AL	6	16T2,5048N	37,70	-	26	10	16	6	0,048
	6	AL	6	16T2,5048N	37,70	-	26	10	16	6	0,048
60	4	AL	6	16T2,5060N	47,25	-	34	10	16	8	0,073
	6	AL	6	16T2,5060N	47,25	-	34	10	16	8	0,073

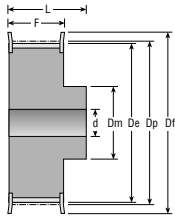

Figur 6F

Z	Rembr. Belt w. Riemenbr.	Mat.	Fig.	Best. nr. Part No. Best. Nr.	De	Df	Dm	F	L	d	Vægt Weight Gewicht
10	10	AL	6F	21T5010N	15,05	19,5	8	15	21	-	0,012
	16	AL	6F	27T5010N	15,05	19,5	8	21	27	-	0,016
	25	AL	6F	36T5010N	15,05	19,5	8	30	36	-	0,023
12	10	AL	6F	21T5012N	18,25	23,0	10	15	21	-	0,016
	16	AL	6F	27T5012N	18,25	23,0	10	21	27	-	0,022
	25	AL	6F	36T5012N	18,25	23,0	10	30	36	-	0,031
14	10	AL	6F	21T5014N	21,45	25,0	13	15	21	-	0,019
	16	AL	6F	27T5014N	21,45	25,0	13	21	27	-	0,026
	25	AL	6F	36T5014N	21,45	25,0	13	30	36	-	0,037
15	10	AL	6F	21T5015N	23,05	28,0	16	15	21	6	0,021
	16	AL	6F	27T5015N	23,05	28,0	16	21	27	6	0,029
	25	AL	6F	36T5015N	23,05	28,0	16	30	36	6	0,041
16	10	AL	6F	21T5016N	24,60	32,0	18	15	21	6	0,025
	16	AL	6F	27T5016N	24,60	32,0	18	21	27	6	0,035
	25	AL	6F	36T5016N	24,60	32,0	18	30	36	6	0,050
18	10	AL	6F	21T5018N	27,80	32,0	19	15	21	6	0,031
	16	AL	6F	27T5018N	27,80	32,0	19	21	27	6	0,043
	25	AL	6F	36T5018N	27,80	32,0	19	30	36	6	0,061
19	10	AL	6F	21T5019N	29,40	36,0	22	15	21	6	0,036
	16	AL	6F	27T5019N	29,40	36,0	22	21	27	6	0,049
	25	AL	6F	36T5019N	29,40	36,0	22	30	36	6	0,070
20	10	AL	6F	21T5020N	31,00	36,0	23	15	21	6	0,038
	16	AL	6F	27T5020N	31,00	36,0	23	21	27	6	0,053
	25	AL	6F	36T5020N	31,00	36,0	23	30	36	6	0,076
22	10	AL	6F	21T5022N	34,25	38,0	24	15	21	6	0,046
	16	AL	6F	27T5022N	34,25	38,0	24	21	27	6	0,054
	25	AL	6F	36T5022N	34,25	38,0	24	30	36	6	0,080
24	10	AL	6F	21T5024N	37,40	42,0	26	15	21	6	0,054
	16	AL	6F	27T5024N	37,40	42,0	26	21	27	6	0,076
	25	AL	6F	36T5024N	37,40	42,0	26	30	36	8	0,109
25	10	AL	6F	21T5025N	39,00	44,0	26	15	21	6	0,058
	16	AL	6F	27T5025N	39,00	44,0	26	21	27	6	0,081
	25	AL	6F	36T5025N	39,00	44,0	26	30	36	8	0,116
26	10	AL	6F	21T5026N	40,60	44,0	26	15	21	6	0,062
	16	AL	6F	27T5026N	40,60	44,0	26	21	27	6	0,085
	25	AL	6F	36T5026N	40,60	44,0	26	30	36	8	0,120
27	10	AL	6F	21T5027N	42,20	48,0	30	15	21	8	0,064
	16	AL	6F	27T5027N	42,20	48,0	30	21	27	8	0,090
	25	AL	6F	36T5027N	42,20	48,0	30	30	36	8	0,128
28	10	AL	6F	21T5028N	43,75	48,0	32	15	21	8	0,071
	16	AL	6F	27T5028N	43,75	48,0	32	21	27	8	0,092
	25	AL	6F	36T5028N	43,75	48,0	32	30	36	8	0,128
30	10	AL	6F	21T5030N	46,95	51,0	34	15	21	8	0,075
	16	AL	6F	27T5030N	46,95	51,0	34	21	27	8	0,105
	25	AL	6F	36T5030N	46,95	51,0	34	30	36	8	0,150

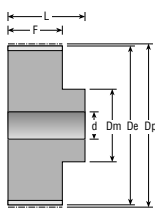
**B2****T5****5 mm****FORBORET
WITH PILOT BORE
VORGEBOHRT**

Figur 6

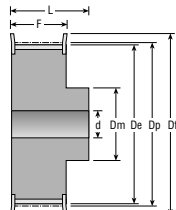

Figur 6F

Z	Rembr. Belt w. Riemenbr.	Mat.	Fig.	Best. nr. Part No. Best. Nr.	De	Df	Dm	F	L	d	Vægt Weight Gewicht
32	10	AL	6F	21T5032N	50,10	54,0	38	15	21	8	0,088
	16	AL	6F	27T5032N	50,10	54,0	38	21	27	8	0,123
	25	AL	6F	36T5032N	50,10	54,0	38	30	36	8	0,176
36	10	AL	6F	21T5036N	56,45	63,0	38	15	21	8	0,114
	16	AL	6F	27T5036N	56,45	63,0	38	21	27	8	0,160
	25	AL	6F	36T5036N	56,45	63,0	38	30	36	8	0,230
40	10	AL	6F	21T5040N	62,85	66,0	40	15	21	8	0,138
	16	AL	6F	27T5040N	62,85	66,0	40	21	27	8	0,193
	25	AL	6F	36T5040N	62,85	66,0	40	30	36	8	0,276
42	10	AL	6F	21T5042N	66,00	71,0	40	15	21	8	0,180
	16	AL	6F	27T5042N	66,00	71,0	40	21	27	8	0,205
	25	AL	6F	36T5042N	66,00	71,0	40	30	36	8	0,284
44	10	AL	6	21T5044N	69,20	-	45	15	21	8	0,185
	16	AL	6	27T5044N	69,20	-	45	21	27	8	0,228
	25	AL	6	36T5044N	69,20	-	45	30	36	8	0,315
48	10	AL	6	21T5048N	75,55	-	50	15	21	8	0,200
	16	AL	6	27T5048N	75,55	-	50	21	27	8	0,280
	25	AL	6	36T5048N	75,55	-	50	30	36	8	0,400
60	10	AL	6	21T5060N	94,65	-	65	15	21	8	0,307
	16	AL	6	27T5060N	94,65	-	65	21	27	8	0,430
	25	AL	6	36T5060N	94,65	-	65	30	36	8	0,614

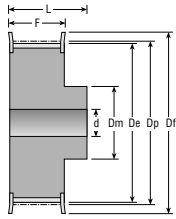

Figur 6F

Z	Rembr. Belt w. Riemenbr.	Mat.	Fig.	Best. nr. Part No. Best. Nr.	De	Df	Dm	F	L	d	Vægt Weight Gewicht
10	10	AL	6F	21AT5010N	14,65	19,5	8	15	21	-	0,012
	16	AL	6F	27AT5010N	14,65	19,5	8	21	27	-	0,016
	25	AL	6F	36AT5010N	14,65	19,5	8	30	36	-	0,023
12	10	AL	6F	21AT5012N	17,85	23,0	10	15	21	-	0,016
	16	AL	6F	27AT5012N	17,85	23,0	10	21	27	-	0,022
	25	AL	6F	36AT5012N	17,85	23,0	10	30	36	-	0,031
14	10	AL	6F	21AT5014N	21,05	25,0	13	15	21	-	0,019
	16	AL	6F	27AT5014N	21,05	25,0	13	21	27	-	0,026
	25	AL	6F	36AT5014N	21,05	25,0	13	30	36	-	0,037
15	10	AL	6F	21AT5015N	22,65	28,0	16	15	21	6	0,021
	16	AL	6F	27AT5015N	22,65	28,0	16	21	27	6	0,029
	25	AL	6F	36AT5015N	22,65	28,0	16	30	36	6	0,041
16	10	AL	6F	21AT5016N	24,20	32,0	18	15	21	6	0,025
	16	AL	6F	27AT5016N	24,20	32,0	18	21	27	6	0,035
	25	AL	6F	36AT5016N	24,20	32,0	18	30	36	6	0,050
18	10	AL	6F	21AT5018N	27,40	32,0	19	15	21	6	0,031
	16	AL	6F	27AT5018N	27,40	32,0	19	21	27	6	0,043
	25	AL	6F	36AT5018N	27,40	32,0	19	30	36	6	0,061
19	10	AL	6F	21AT5019N	29,00	36,0	22	15	21	6	0,036
	16	AL	6F	27AT5019N	29,00	36,0	22	21	27	6	0,049
	25	AL	6F	36AT5019N	29,00	36,0	22	30	36	6	0,070
20	10	AL	6F	21AT5020N	30,60	36,0	23	15	21	6	0,038
	16	AL	6F	27AT5020N	30,60	36,0	23	21	27	6	0,053
	25	AL	6F	36AT5020N	30,60	36,0	23	30	36	6	0,076
22	10	AL	6F	21AT5022N	33,85	38,0	24	15	21	6	0,046
	16	AL	6F	27AT5022N	33,85	38,0	24	21	27	6	0,054
	25	AL	6F	36AT5022N	33,85	38,0	24	30	36	6	0,080
24	10	AL	6F	21AT5024N	37,00	42,0	26	15	21	6	0,054
	16	AL	6F	27AT5024N	37,00	42,0	26	21	27	6	0,076
	25	AL	6F	36AT5024N	37,00	42,0	26	30	36	8	0,109
25	10	AL	6F	21AT5025N	38,60	44,0	26	15	21	6	0,058
	16	AL	6F	27AT5025N	38,60	44,0	26	21	27	6	0,081
	25	AL	6F	36AT5025N	38,60	44,0	26	30	36	8	0,116
26	10	AL	6F	21AT5026N	40,20	44,0	26	15	21	6	0,062
	16	AL	6F	27AT5026N	40,20	44,0	26	21	27	6	0,085
	25	AL	6F	36AT5026N	40,20	44,0	26	30	36	8	0,120
27	10	AL	6F	21AT5027N	41,80	48,0	30	15	21	8	0,064
	16	AL	6F	27AT5027N	41,80	48,0	30	21	27	8	0,090
	25	AL	6F	36AT5027N	41,80	48,0	30	30	36	8	0,128
28	10	AL	6F	21AT5028N	43,35	48,0	32	15	21	8	0,071
	16	AL	6F	27AT5028N	43,35	48,0	32	21	27	8	0,092
	25	AL	6F	36AT5028N	43,35	48,0	32	30	36	8	0,128
30	10	AL	6F	21AT5030N	46,55	51,0	34	15	21	8	0,075
	16	AL	6F	27AT5030N	46,55	51,0	34	21	27	8	0,105
	25	AL	6F	36AT5030N	46,55	51,0	34	30	36	8	0,150

**B2**

AT5

5 mm

FORBORET WITH PILOT BORE VORGEBOHRT

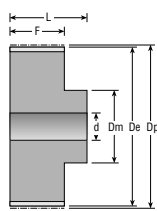

Figur 6

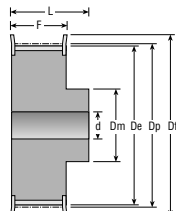

Figur 6F

Z	Rembr. Belt w. Riemenbr.	Mat.	Fig.	Best. nr. Part No. Best. Nr.	De	Df	Dm	F	L	d	Vægt Weight Gewicht
32	10	AL	6F	21AT5032N	49,70	54,0	38	15	21	8	0,088
	16	AL	6F	27AT5032N	49,70	54,0	38	21	27	8	0,123
	25	AL	6F	36AT5032N	49,70	54,0	38	30	36	8	0,176
36	10	AL	6F	21AT5036N	56,05	63,0	38	15	21	8	0,114
	16	AL	6F	27AT5036N	56,05	63,0	38	21	27	8	0,160
	25	AL	6F	36AT5036N	56,05	63,0	38	30	36	8	0,230
40	10	AL	6F	21AT5040N	62,45	66,0	40	15	21	8	0,138
	16	AL	6F	27AT5040N	62,45	66,0	40	21	27	8	0,193
	25	AL	6F	36AT5040N	62,45	66,0	40	30	36	8	0,276
42	10	AL	6F	21AT5042N	65,60	71,0	40	15	21	8	0,180
	16	AL	6F	27AT5042N	65,60	71,0	40	21	27	8	0,205
	25	AL	6F	36AT5042N	65,60	71,0	40	30	36	8	0,284
44	10	AL	6	21AT5044N	68,80	-	45	15	21	8	0,185
	16	AL	6	27AT5044N	68,80	-	45	21	27	8	0,228
	25	AL	6	36AT5044N	68,80	-	45	30	36	8	0,315
48	10	AL	6	21AT5048N	75,15	-	50	15	21	8	0,200
	16	AL	6	27AT5048N	75,15	-	50	21	27	8	0,280
	25	AL	6	36AT5048N	75,15	-	50	30	36	8	0,400
60	10	AL	6	21AT5060N	94,25	-	65	15	21	8	0,307
	16	AL	6	27AT5060N	94,25	-	65	21	27	8	0,430
	25	AL	6	36AT5060N	94,25	-	65	30	36	8	0,614

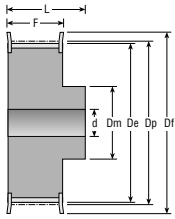

Figur 6F

Z	Rembr. Belt w. Riemenbr.	Mat.	Fig.	Best. nr. Part No. Best. Nr.	De	Df	Dm	F	L	d	Vægt Weight Gewicht
12	16	AL	6F	31T10012N	36,35	42	28	21	31	6	0,076
	25	AL	6F	40T10012N	36,35	42	28	30	40	6	0,099
14	16	AL	6F	31T10014N	42,70	48	32	21	31	8	0,104
	25	AL	6F	40T10014N	42,70	48	32	30	40	8	0,134
15	16	AL	6F	31T10015N	45,90	51	32	21	31	8	0,116
	25	AL	6F	40T10015N	45,90	51	32	30	40	8	0,152
16	16	AL	6F	31T10016N	49,05	54	35	21	31	8	0,134
	25	AL	6F	40T10016N	49,05	54	35	30	40	8	0,176
18	16	AL	6F	31T10018N	55,45	60	40	21	31	8	0,167
	25	AL	6F	40T10018N	55,45	60	40	30	40	8	0,224
	32	AL	6F	47T10018N	55,45	60	40	37	47	10	0,253
	50	AL	6F	66T10018N	55,45	60	40	56	66	10	0,422
19	16	AL	6F	31T10019N	58,60	66	44	21	31	8	0,184
	25	AL	6F	40T10019N	58,60	66	44	30	40	8	0,247
	32	AL	6F	47T10019N	58,60	66	44	37	47	10	0,286
	50	AL	6F	66T10019N	58,60	66	44	56	66	10	0,466
20	16	AL	6F	31T10020N	61,80	66	46	21	31	8	0,208
	25	AL	6F	40T10020N	61,80	66	46	30	40	8	0,276
	32	AL	6F	47T10020N	61,80	66	46	37	47	12	0,322
	50	AL	6F	66T10020N	61,80	66	46	56	66	12	0,520
22	16	AL	6F	31T10022N	68,15	75	52	21	31	8	0,253
	25	AL	6F	40T10022N	68,15	75	52	30	40	8	0,337
	32	AL	6F	47T10022N	68,15	75	52	37	47	12	0,393
	50	AL	6F	66T10022N	68,15	75	52	56	66	12	0,570
24	16	AL	6F	31T10024N	74,55	83	58	21	31	8	0,288
	25	AL	6F	40T10024N	74,55	83	58	30	40	8	0,392
	32	AL	6F	47T10024N	74,55	83	58	37	47	12	0,475
	50	AL	6F	66T10024N	74,55	83	58	56	66	12	0,736
25	16	AL	6F	31T10025N	77,70	83	60	21	31	8	0,310
	25	AL	6F	40T10025N	77,70	83	60	30	40	8	0,422
	32	AL	6F	47T10025N	77,70	83	60	37	47	12	0,527
	50	AL	6F	66T10025N	77,70	83	60	56	66	12	0,766
26	16	AL	6F	31T10026N	80,90	87	60	21	31	8	0,357
	25	AL	6F	40T10026N	80,90	87	60	30	40	8	0,477
	32	AL	6F	47T10026N	80,90	87	60	37	47	12	0,564
	50	AL	6F	66T10026N	80,90	87	60	56	66	12	0,816
27	16	AL	6F	31T10027N	84,10	91	60	21	31	8	0,364
	25	AL	6F	40T10027N	84,10	91	60	30	40	8	0,536
	32	AL	6F	47T10027N	84,10	91	60	37	47	12	0,602
	50	AL	6F	66T10027N	84,10	91	60	56	66	12	0,946
28	16	AL	6F	31T10028N	87,25	93	60	21	31	8	0,401
	25	AL	6F	40T10028N	87,25	93	60	30	40	8	0,540
	32	AL	6F	47T10028N	87,25	93	60	37	47	12	0,642
	50	AL	6F	66T10028N	87,25	93	60	56	66	12	0,960

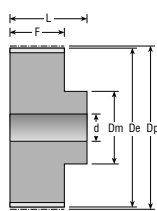

B2

T 10**10 mm****FORBORET
WITH PILOT BORE
VORGEBOHRT**

Figur 6

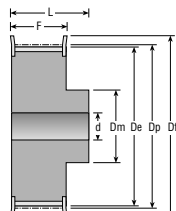

Figur 6F

Z	Rembr. Belt w. Riemenbr.	Mat.	Fig.	Best. nr. Part No. Best. Nr.	De	Df	Dm	F	L	d	Vægt Weight Gewicht
30	16	AL	6F	31T10030N	93,65	97	60	21	31	8	0,441
	25	AL	6F	40T10030N	93,65	97	60	30	40	8	0,640
	32	AL	6F	47T10030N	93,65	97	60	37	47	12	0,740
	50	AL	6F	66T10030N	93,65	97	60	56	66	12	1,169
32	16	AL	6F	31T10032N	100,00	106	65	21	31	10	0,493
	25	AL	6F	40T10032N	100,00	106	65	30	40	10	0,693
	32	AL	6F	47T10032N	100,00	106	65	37	47	12	0,844
	50	AL	6F	66T10032N	100,00	106	65	56	66	12	1,300
36	16	AL	6F	31T10036N	112,75	119	70	21	31	10	0,623
	25	AL	6F	40T10036N	112,75	119	70	30	40	10	0,873
	32	AL	6F	47T10036N	112,75	119	70	37	47	16	1,083
	50	AL	6F	66T10036N	112,75	119	70	56	66	16	1,637
40	16	AL	6F	31T10040N	125,45	131	80	21	31	10	0,767
	25	AL	6F	40T10040N	125,45	131	80	30	40	10	1,067
	32	AL	6F	47T10040N	125,45	131	80	37	47	16	1,317
	50	AL	6F	66T10040N	125,45	131	80	56	66	16	1,999
44	16	AL	6	31T10044N	138,20	-	88	21	31	10	0,993
	25	AL	6	40T10044N	138,20	-	88	30	40	10	1,350
	32	AL	6	47T10044N	138,20	-	88	37	47	16	1,611
	50	AL	6	66T10044N	138,20	-	88	56	66	16	2,357
48	16	AL	6	31T10048N	150,95	-	95	21	31	16	1,090
	25	AL	6	40T10048N	150,95	-	95	30	40	16	1,516
	32	AL	6	47T10048N	150,95	-	95	37	47	16	1,931
	50	AL	6	66T10048N	150,95	-	95	56	66	16	2,830
60	16	AL	6	31T10060N	189,10	-	110	21	31	16	1,710
	25	AL	6	40T10060N	189,10	-	110	30	40	16	2,339
	32	AL	6	47T10060N	189,10	-	110	37	47	16	3,004
	50	AL	6	66T10060N	189,10	-	110	56	66	16	4,366

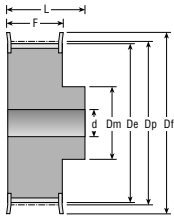

Figur 6F

Z	Rembr. Belt w. Riemenbr.	Mat.	Fig.	Best. nr. Part No. Best. Nr.	De	Df	Dm	F	L	d	Vægt Weight Gewicht
12	16	AL	6F	31AT10012N	36,35	42	28	21	31	6	0,076
	25	AL	6F	40AT10012N	36,35	42	28	30	40	6	0,099
14	16	AL	6F	31AT10014N	42,70	48	32	21	31	8	0,104
	25	AL	6F	40AT10014N	42,70	48	32	30	40	8	0,134
15	16	AL	6F	31AT10015N	45,90	51	32	21	31	8	0,116
	25	AL	6F	40AT10015N	45,90	51	32	30	40	8	0,152
16	16	AL	6F	31AT10016N	49,05	54	35	21	31	8	0,134
	25	AL	6F	40AT10016N	49,05	54	35	30	40	8	0,176
18	16	AL	6F	31AT10018N	55,45	60	40	21	31	8	0,167
	25	AL	6F	40AT10018N	55,45	60	40	30	40	8	0,224
	32	AL	6F	47AT10018N	55,45	60	40	37	47	10	0,253
	50	AL	6F	66AT10018N	55,45	60	40	56	66	10	0,422
19	16	AL	6F	31AT10019N	58,60	66	44	21	31	8	0,184
	25	AL	6F	40AT10019N	58,60	66	44	30	40	8	0,247
	32	AL	6F	47AT10019N	58,60	66	44	37	47	10	0,286
	50	AL	6F	66AT10019N	58,60	66	44	56	66	10	0,466
20	16	AL	6F	31AT10020N	61,80	66	46	21	31	8	0,208
	25	AL	6F	40AT10020N	61,80	66	46	30	40	8	0,276
	32	AL	6F	47AT10020N	61,80	66	46	37	47	12	0,322
	50	AL	6F	66AT10020N	61,80	66	46	56	66	12	0,520
22	16	AL	6F	31AT10022N	68,15	75	52	21	31	8	0,253
	25	AL	6F	40AT10022N	68,15	75	52	30	40	8	0,337
	32	AL	6F	47AT10022N	68,15	75	52	37	47	12	0,393
	50	AL	6F	66AT10022N	68,15	75	52	56	66	12	0,570
24	16	AL	6F	31AT10024N	74,55	83	58	21	31	8	0,288
	25	AL	6F	40AT10024N	74,55	83	58	30	40	8	0,392
	32	AL	6F	47AT10024N	74,55	83	58	37	47	12	0,475
	50	AL	6F	66AT10024N	74,55	83	58	56	66	12	0,736
25	16	AL	6F	31AT10025N	77,70	83	60	21	31	8	0,310
	25	AL	6F	40AT10025N	77,70	83	60	30	40	8	0,422
	32	AL	6F	47AT10025N	77,70	83	60	37	47	12	0,527
	50	AL	6F	66AT10025N	77,70	83	60	56	66	12	0,766
26	16	AL	6F	31AT10026N	80,90	87	60	21	31	8	0,357
	25	AL	6F	40AT10026N	80,90	87	60	30	40	8	0,477
	32	AL	6F	47AT10026N	80,90	87	60	37	47	12	0,564
	50	AL	6F	66AT10026N	80,90	87	60	56	66	12	0,816
27	16	AL	6F	31AT10027N	84,10	91	60	21	31	8	0,364
	25	AL	6F	40AT10027N	84,10	91	60	30	40	8	0,536
	32	AL	6F	47AT10027N	84,10	91	60	37	47	12	0,602
	50	AL	6F	66AT10027N	84,10	91	60	56	66	12	0,946
28	16	AL	6F	31AT10028N	87,25	93	60	21	31	8	0,401
	25	AL	6F	40AT10028N	87,25	93	60	30	40	8	0,540
	32	AL	6F	47AT10028N	87,25	93	60	37	47	12	0,642
	50	AL	6F	66AT10028N	87,25	93	60	56	66	12	0,960



AT 10

B2

10 mm

**FORBORET
WITH PILOT BORE
VORGEBOHRT**

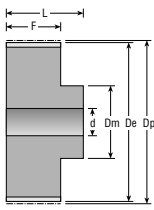

Figur 6

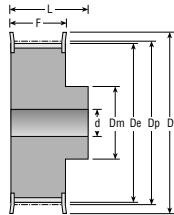

Figur 6F

Z	Rembr. Belt w. Riemenbr.	Mat.	Fig.	Best. nr. Part No. Best. Nr.	De	Df	Dm	F	L	d	Vægt Weight Gewicht
30	16	AL	6F	31AT10030N	93,65	97	60	21	31	8	0,441
	25	AL	6F	40AT10030N	93,65	97	60	30	40	8	0,640
	32	AL	6F	47AT10030N	93,65	97	60	37	47	12	0,740
	50	AL	6F	66AT10030N	93,65	97	60	56	66	12	1,169
32	16	AL	6F	31AT10032N	100,00	106	65	21	31	10	0,493
	25	AL	6F	40AT10032N	100,00	106	65	30	40	10	0,693
	32	AL	6F	47AT10032N	100,00	106	65	37	47	12	0,844
	50	AL	6F	66AT10032N	100,00	106	65	56	66	12	1,300
36	16	AL	6F	31AT10036N	112,75	119	70	21	31	10	0,623
	25	AL	6F	40AT10036N	112,75	119	70	30	40	10	0,873
	32	AL	6F	47AT10036N	112,75	119	70	37	47	16	1,083
	50	AL	6F	66AT10036N	112,75	119	70	56	66	16	1,637
40	16	AL	6F	31AT10040N	125,45	131	80	21	31	10	0,767
	25	AL	6F	40AT10040N	125,45	131	80	30	40	10	1,067
	32	AL	6F	47AT10040N	125,45	131	80	37	47	16	1,317
	50	AL	6F	66AT10040N	125,45	131	80	56	66	16	1,999
44	16	AL	6	31AT10044N	138,20	-	88	21	31	10	0,993
	25	AL	6	40AT10044N	138,20	-	88	30	40	10	1,350
	32	AL	6	47AT10044N	138,20	-	88	37	47	16	1,611
	50	AL	6	66AT10044N	138,20	-	88	56	66	16	2,357
48	16	AL	6	31AT10048N	150,95	-	95	21	31	16	1,090
	25	AL	6	40AT10048N	150,95	-	95	30	40	16	1,516
	32	AL	6	47AT10048N	150,95	-	95	37	47	16	1,931
	50	AL	6	66AT10048N	150,95	-	95	56	66	16	2,830
60	16	AL	6	31AT10060N	189,10	-	110	21	31	16	1,710
	25	AL	6	40AT10060N	189,10	-	110	30	40	16	2,339
	32	AL	6	47AT10060N	189,10	-	110	37	47	16	3,004
	50	AL	6	66AT10060N	189,10	-	110	56	66	16	4,366